

See V1K Installation Guide For Terminal Wire Size And Torque Information.

Note: Maintain Clearance of 3 Inches On All Sides To Other Equipment.

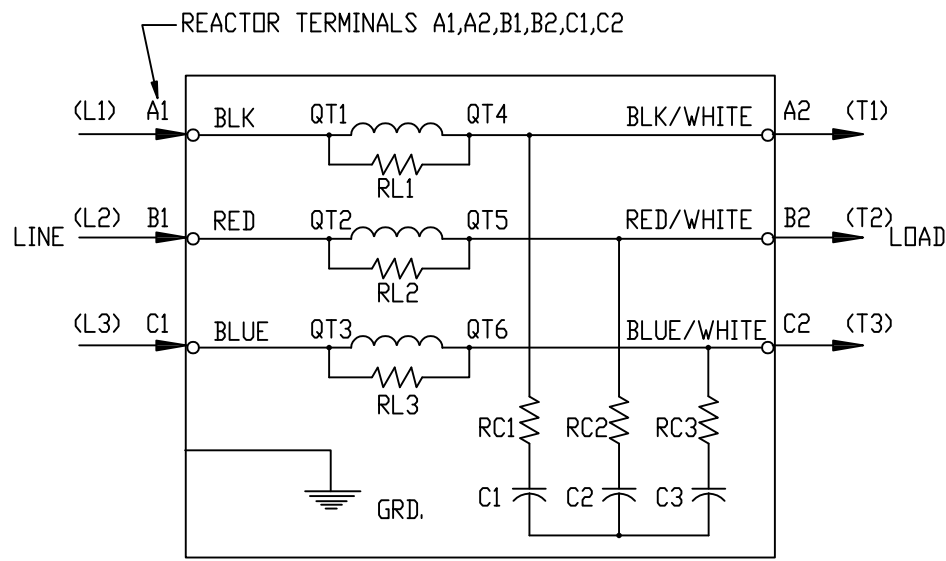

REACTOR AND BOARD ASSEMBLY CONNECTIONS

(Customer Connections) Markings On Terminal Block For Reference Only.

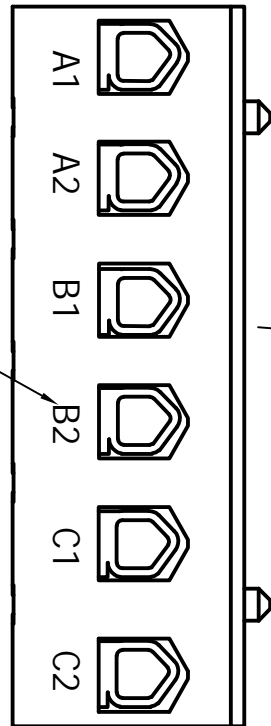

Back Of V1K Mounted Against Wall

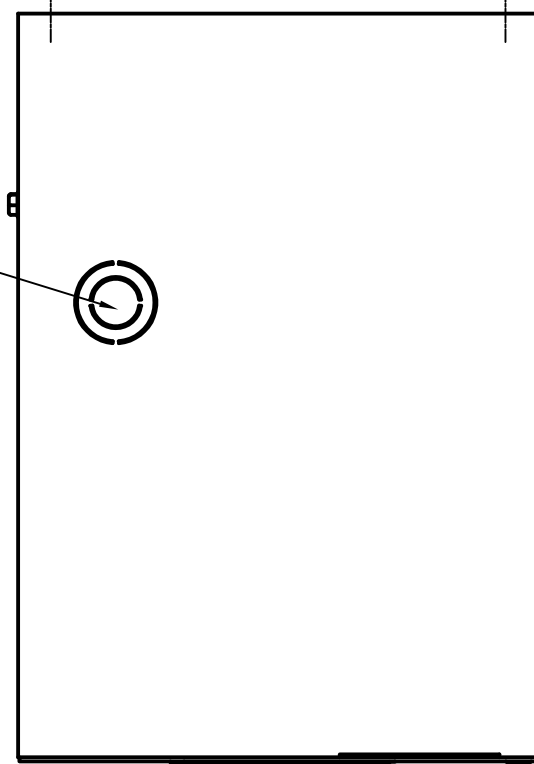

7/8-1-1/8 Knockouts 3 Places. For Customer Entry Options.

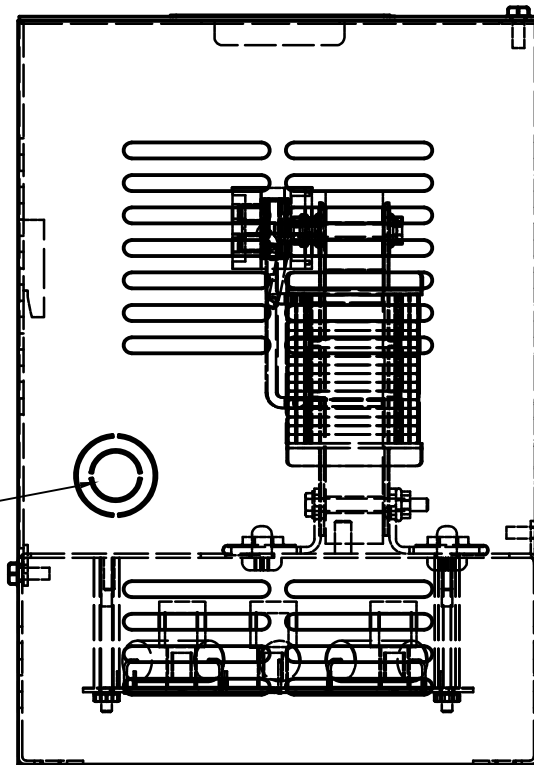
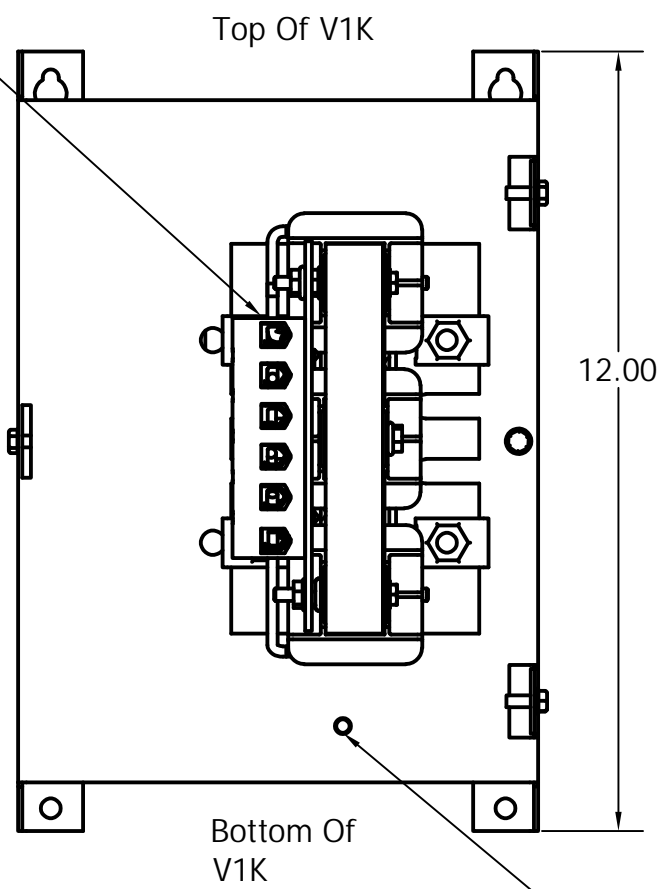

V1K Part Number	Rated Voltage	Amps	Phase	Weight (LBS)
V1K35A01	600	35	3	23
V1K35A01EX	600	35	3	23
V1K45A01	600	45	3	23
V1K45A01EX	600	45	3	23
V1K55A01	600	55	3	23
V1K55A01EX	600	55	3	23

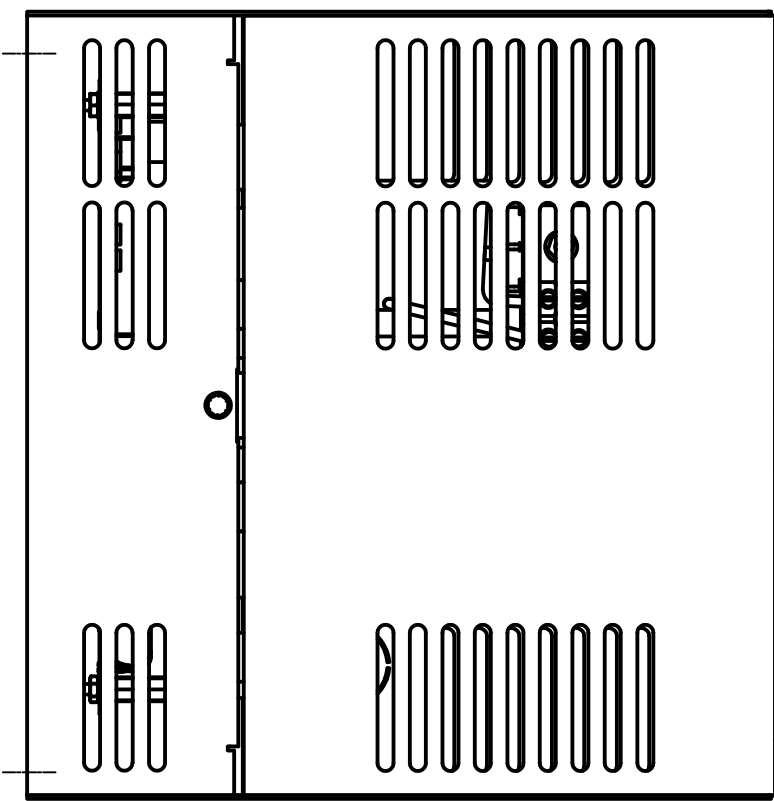

Front Of V1k With Cover.

Product Label.

Information Label.

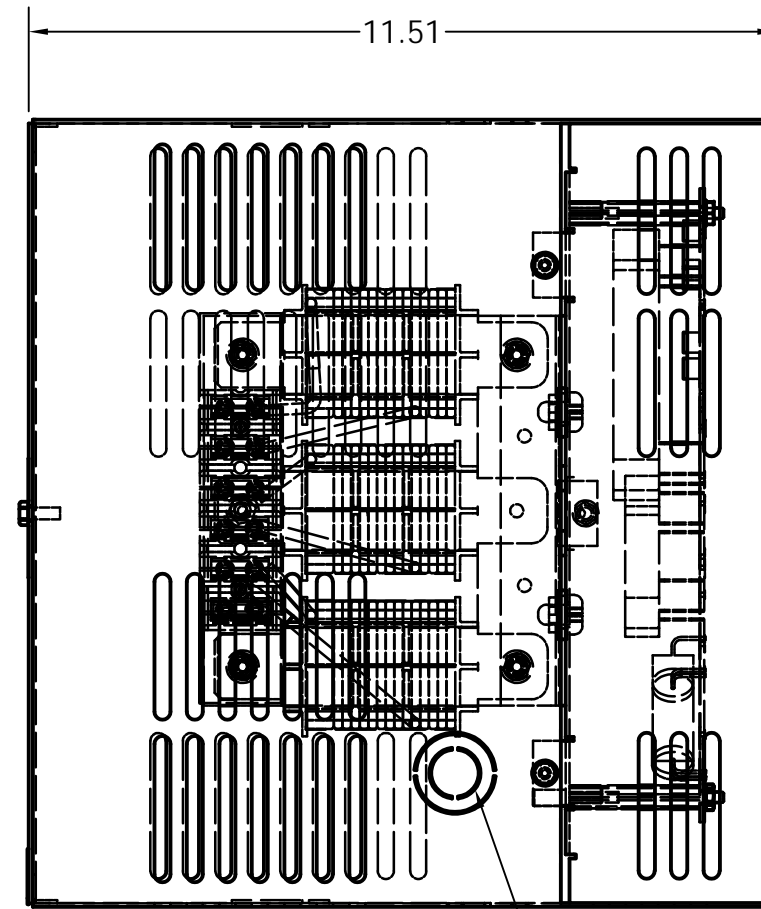

0.31 Dia Holes 2 Places.

Knockout

0.31 Dia Holes 4 Places.

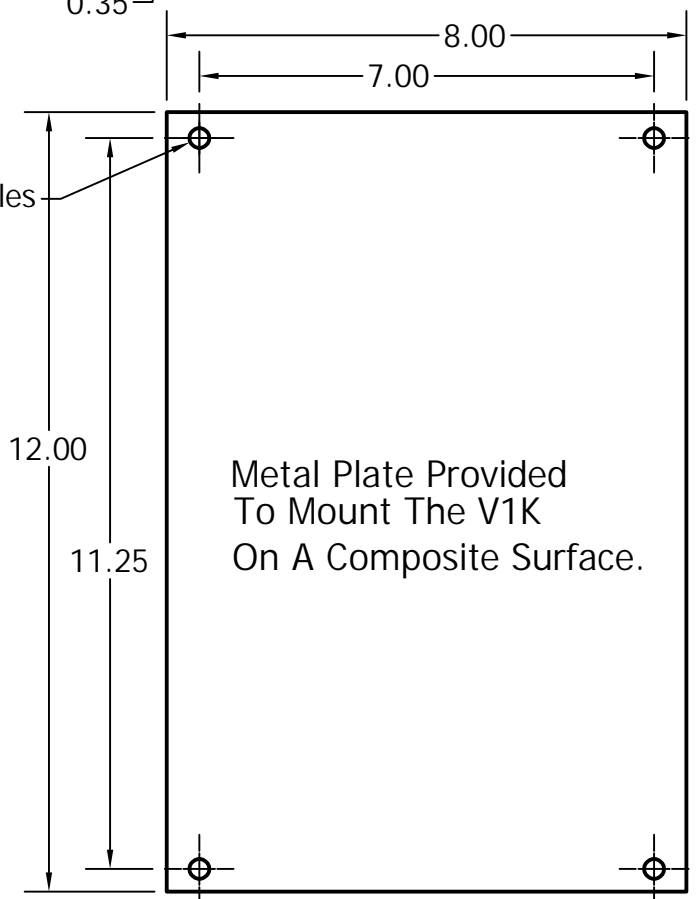
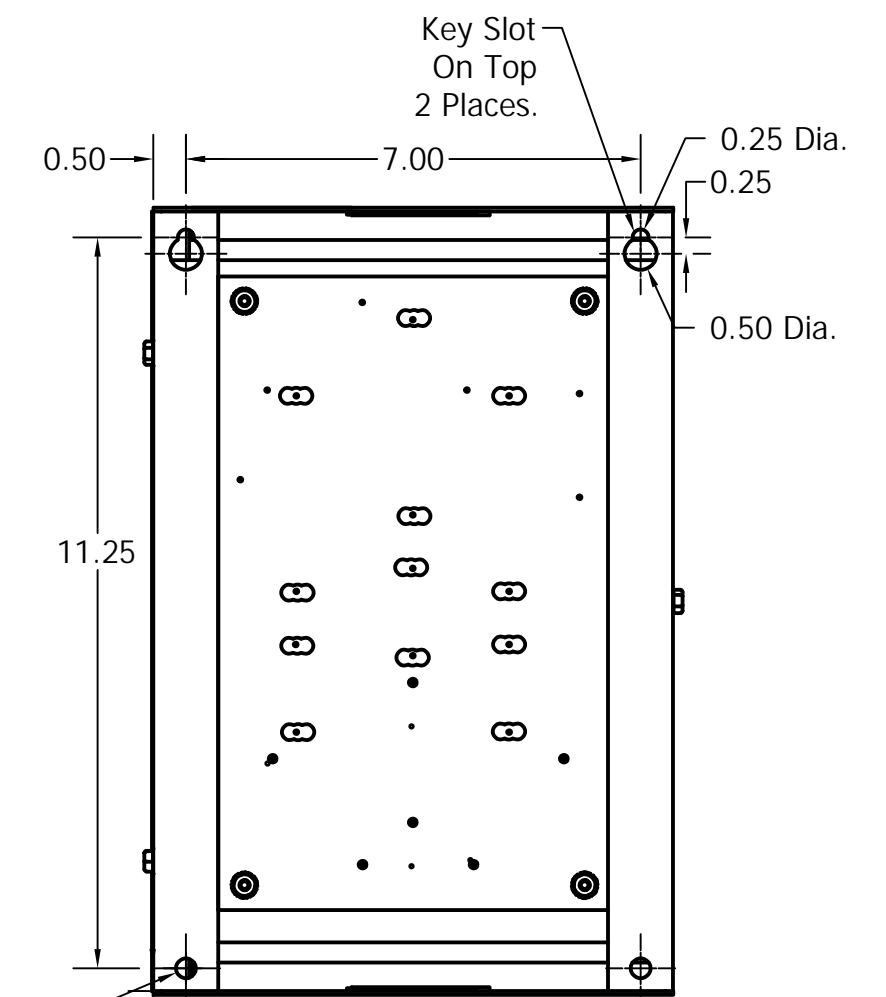

Metal Plate Provided To Mount The V1K On A Composite Surface.

Customer Is Responsible For Installation to Meet All National And Local Electrical Codes.

Material(s) Shall be RoHS Compliant

<p>TCL, LLC CLAIMS PROPRIETARY RIGHTS IN THE MATERIAL HEREIN DISCLOSED. IT IS SUPPLIED WITHOUT PREJUDICE TO ANY PATENT RIGHTS OF TCL AND MAY NOT BE REPRODUCED OR USED TO MANUFACTURE ANYTHING SHOWN THEREIN WITHOUT WRITTEN PERMISSION FROM TCL.</p>				TOLERANCES (EXCEPT AS NOTED)	W132 N10611 Grant Drive Germantown, WI 53022
				DECIMAL	
				.XX ± .25 .XXX ± .10	
				FRACTIONAL ± 1/16	
	F 4030, Combine V1K Drawings	6/23/17		ANGULAR ± 1°	<p>V1K, Enclosed, TYPE 1 35 Amps to 55 Amps</p>
	NO REVISION	DATE	BY	SCALE TO FIT	<p>DRN BY: DSW DATE: 4/26/17 APRVD: SIZE: 102403DG SHT 1 OF 1</p>