

Parts List			
TCI Part #	Description	Quantity	Item #
14926	Lug 2/0	6	1
1745	Hex Hd Bolt 1/4-20 X 1 In	6	2
1505	Nut 1/4-20	7	3
1763	Flat Washer 1/4"	6	4
14928	Lug Two 2/0	1	5
2934	Hex Hd Bolt 1/4-20 X 3/4 In	1	6

Lug Kit Part #LK00

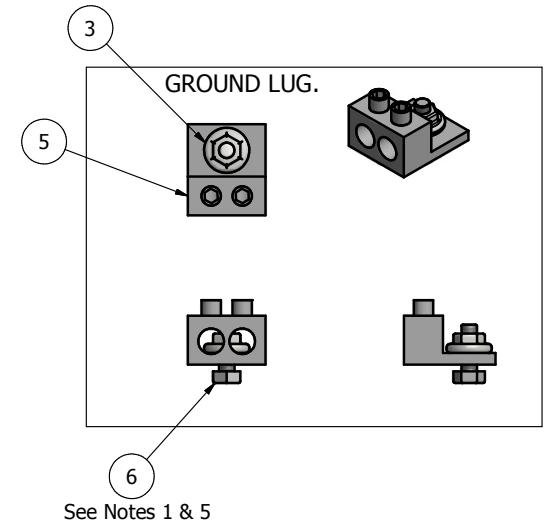
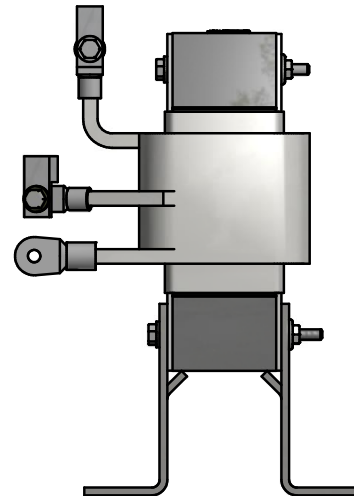
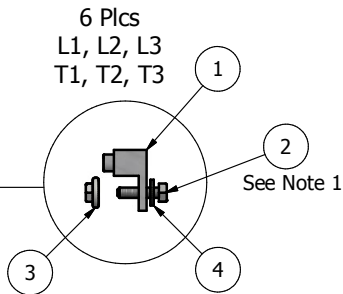
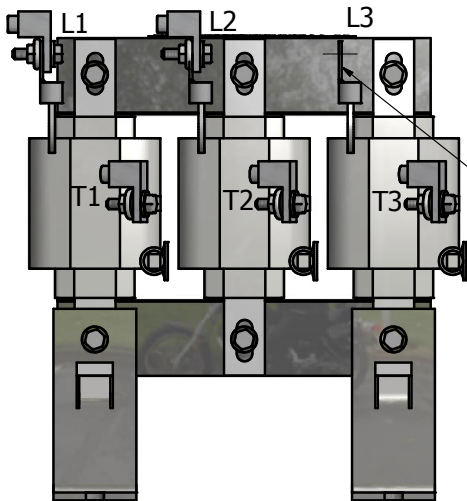

Notes:

- 1.) Torque bolts to 66 in-lb (7.5 N-m).
- 2.) All terminals are rated for aluminum or copper wire.
- 3.) Field wiring terminal rating, 2/0 to 14 Awg.
- 4.) Field wiring terminal tightening torque is: Cu 50 in-lbs (5.6 N-m).
- 5.) Use hole provided in enclosure bottom for mounting. CAUTION: To ensure proper bonding lug should be metal to metal contact with enclosure.

Follow NEC guidelines to determine acceptable wire ampacity requirements.

				TOLERANCES (EXCEPT AS NOTED)		<b>W132 N10611 Grant Drive Germantown, WI 53022</b>	
				DECIMAL			
				.XX ± .03		<b>Lug Kit, 2/0-14, With Ground, 2-2/0-14</b>	
				.XXX ± .010			
				FRACTIONAL		DRN. BY: <b>DSW</b> DATE: 7/18/16      LK00-Dwg	
				± 1/32		SCALE:      APRVD:      SIZE: <b>B</b>	
				ANGULAR		NO.      REVISION      DATE      BY      1	
				± 1°		SHT. 1 OF 1	