

TCI Part Number	Rated Amps (A)	Rated Voltage (V)	Hz	---uH ±5%	Approx Weight (LBS)
KTRMG600AX8	600	480	60	80	465

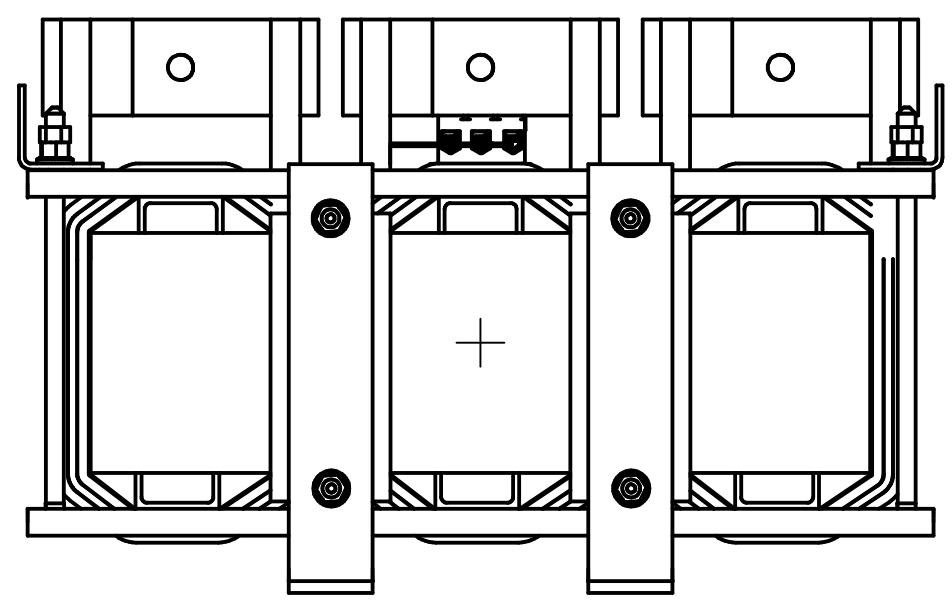
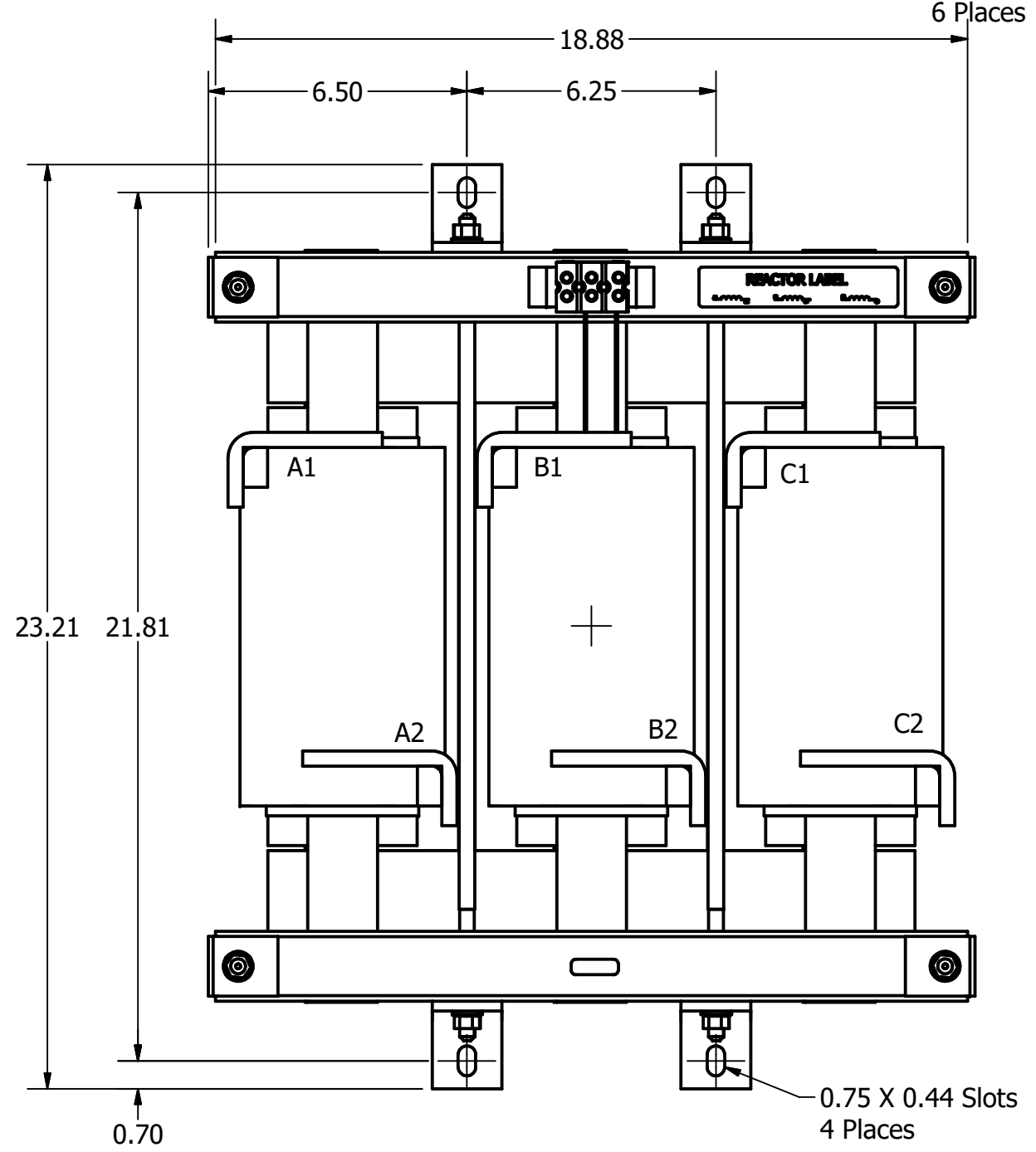
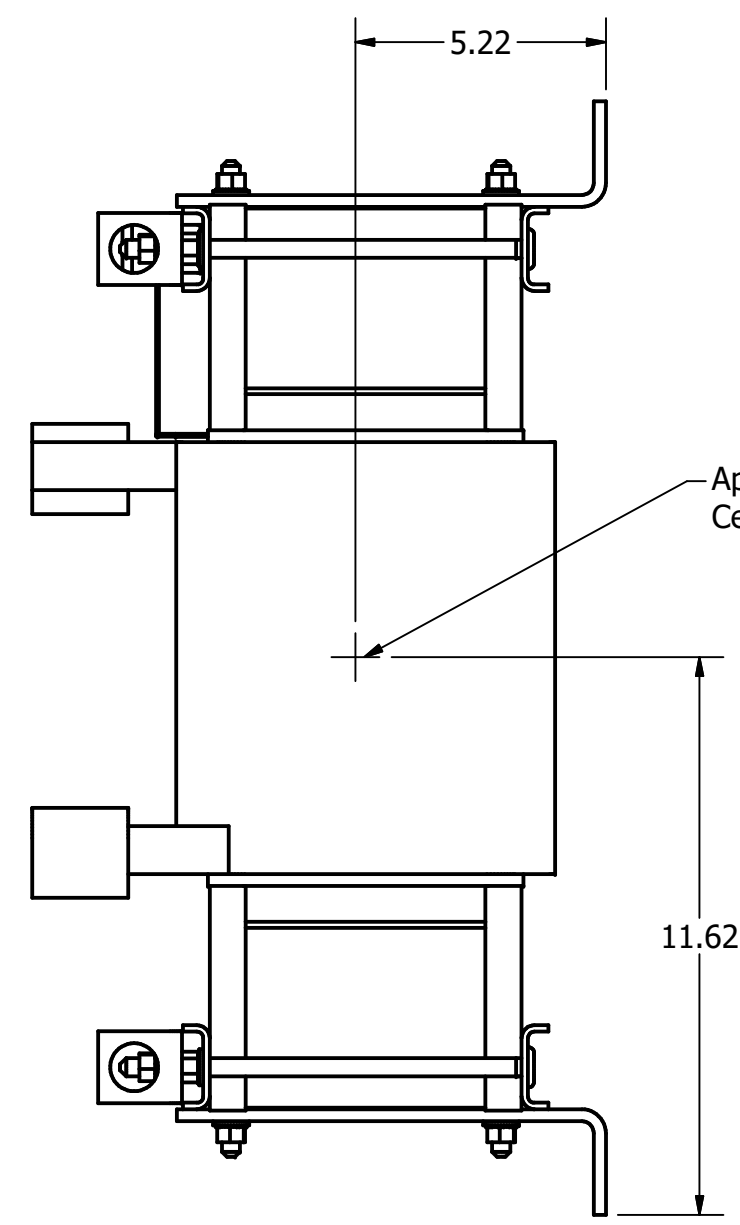
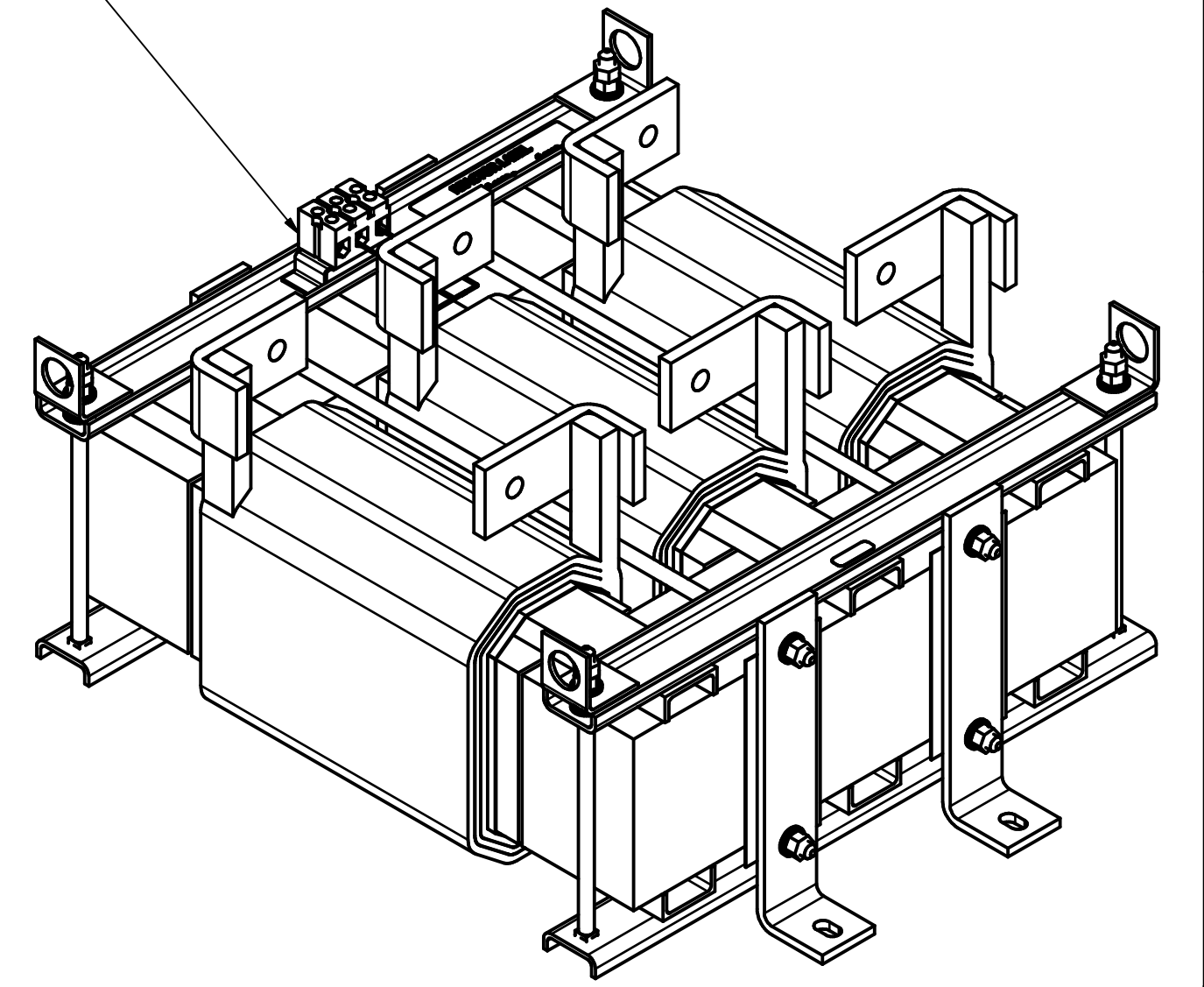
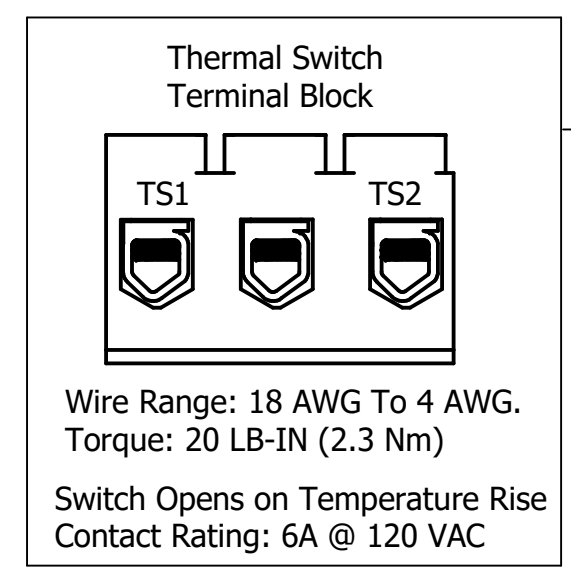
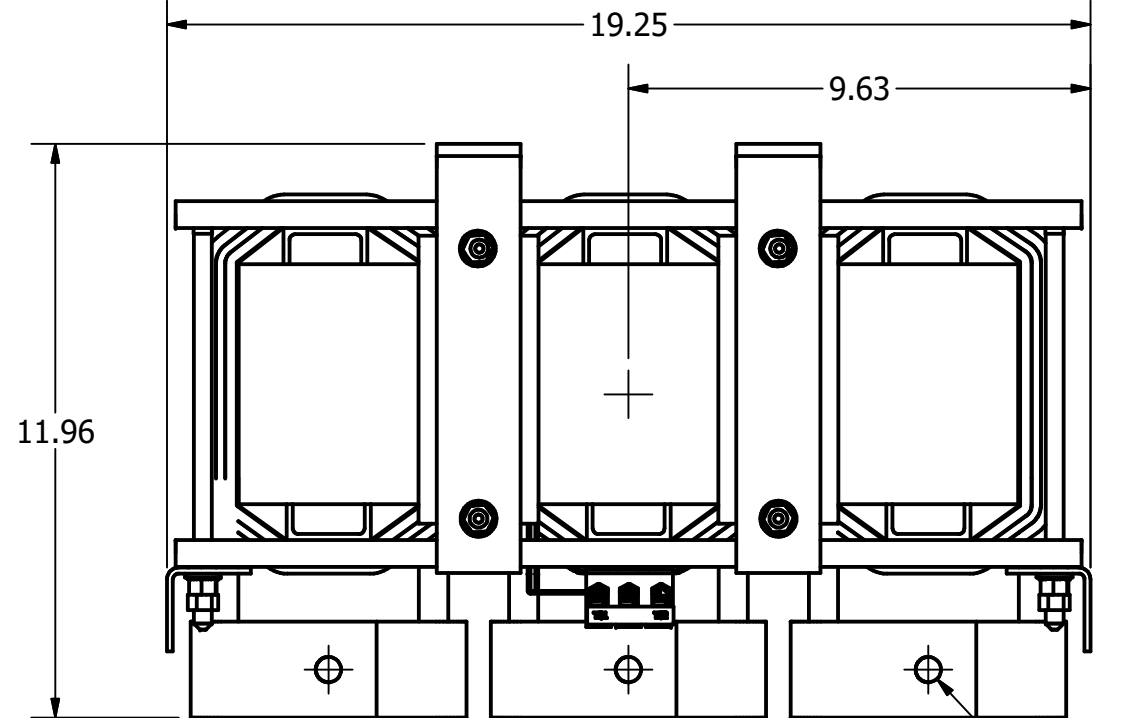

TCI, LLC  
 Germantown, WI  
 www.transcoll.com  
 800-824-8282

**KDR Drive Reactor**  
 KTRMG— (Motor Amps) Or (Rating Amps)  
 3 PH, 50/60Hz, 600V Max. —Max.  
 40C Amb Max, 155C Res.

(800) 824-8282 • transcoll.com

TCI, LLC CLAIMS PROPRIETARY RIGHTS IN THE MATERIAL HEREIN DISCLOSED. IT IS SUPPLIED WITHOUT PREJUDICE TO ANY PATENT RIGHTS OF TCI AND MAY NOT BE REPRODUCED OR USED TO MANUFACTURE ANYTHING SHOWN THEREIN WITHOUT WRITTEN PERMISSION FROM TCI.				TOLERANCES (EXCEPT AS NOTED) DECIMAL .XX ± .25 .XXX ± .10 FRACTIONAL ± 1/16 ANGULAR ± 1°		Material(s) Shall be RoHS Compliant	
Customer Is Responsible For Installation to Meet All National And Local Electrical Codes.				W132 N10611 Grant Drive Germantown, WI 53022		Sinewave Reactor, Wall Mounted KTRMG600AX8, 480V, 500HP	
A	As Designed	07/15/20	JRN	DRN BY JRN	DATE 07/15/20	108685DG	SIZE C
NO	REVISION	DATE	BY	SCALE 1/4	APRVD:	SHT 1 OF 1	