

TCI Part Number	Horsepower (HP)	Rated Amps (A)	---uH +8%/-2%	Weight (LBS)
KTR10A65XHL	75	25.3	2580	55

System Voltage 480v, 289Hz.

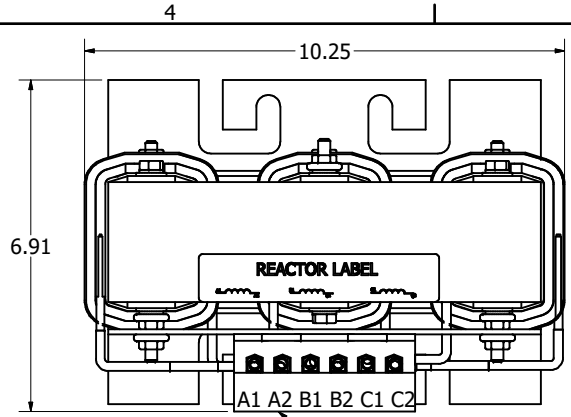

Markings On Coil And Terminal Block For Reference Only.

Wire Range:
1AWG (7 & 19 strand only), 2 AWG to 22AWG
Tightening Torque:
1AWG thru 4AWG 35 in.-lb. max
6AWG thru 14AWG 30 in.-lb. max
16AWG thru 22AWG 25 in.-lb. max

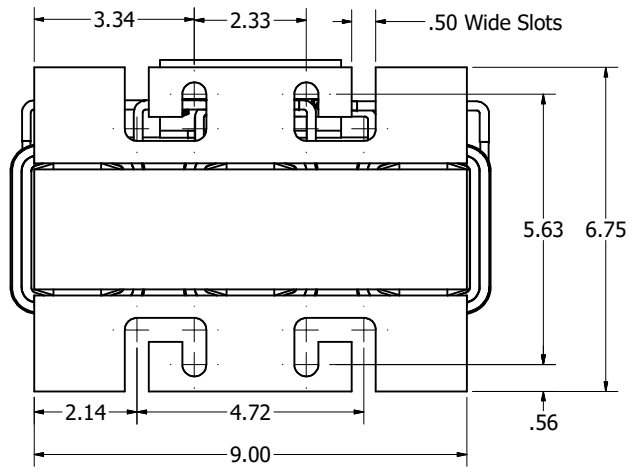
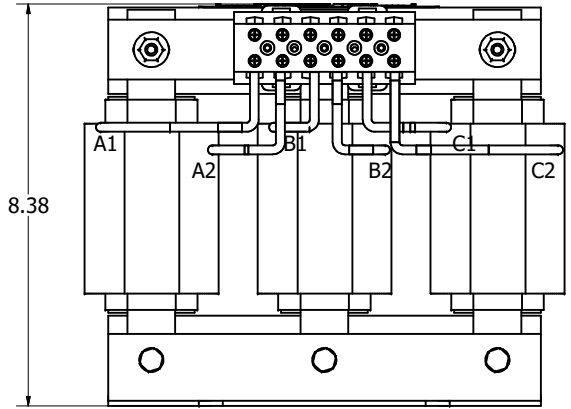
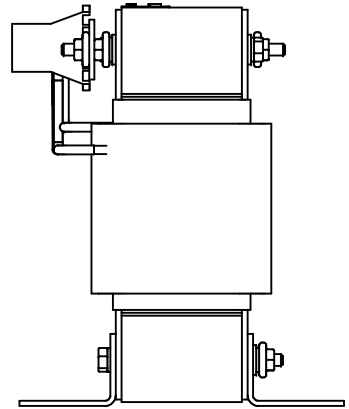
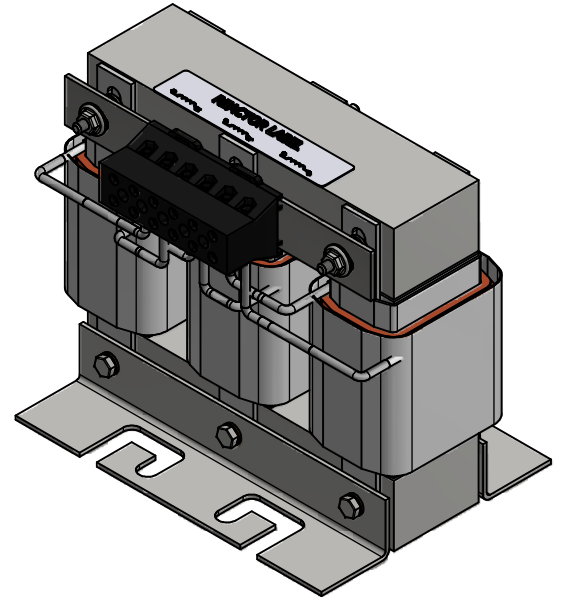

Customer Is Responsible For Installation to Meet All National And Local Electrical Codes.

Material(s) Shall be RoHS Compliant

TCI, LLC CLAIMS PROPRIETARY RIGHTS IN THE MATERIAL HEREIN DISCLOSED. IT IS SUPPLIED WITHOUT PREJUDICE TO ANY PATENT RIGHTS OF TCI AND MAY NOT BE REPRODUCED OR USED TO MANUFACTURE ANYTHING SHOWN THEREIN WITHOUT WRITTEN PERMISSION FROM TCI.					TOLERANCES (EXCEPT AS NOTED) DECIMAL .XX ± .25 .XXX ± .10	TCI W132 N10611 Grant Drive Germantown, WI 53022 Tuning Inductor, 75HP, 25.3 Amps, 480V, (High Inductance)	
	B	5271 Design updated	5/19/2020	DSW	FRACTIONAL ± 1/16		
	A	As Designed	1/13/18	DSW	ANGULAR ± 1°	DRN BY: DSW DATE: 10/26/15 SCALE:	107524DG FIG. 1 SHEET 1 OF 1
	NO	REVISION	DATE	BY			