

KPCUL003A60, 480V, 3kVar, 7.5HP, 10HP.
 APPROX. WEIGHT: 4.8LBS
 SEE DRAWING# 28697-2S FOR SCHEMATIC

TORQUE(LB-IN)=CUSTOMER WIRE
 35=1 AWG THRU 4 AWG
 30=6 AWG THRU 14 AWG
 25=16 AWG THRU 20 AWG
 20=22 AWG

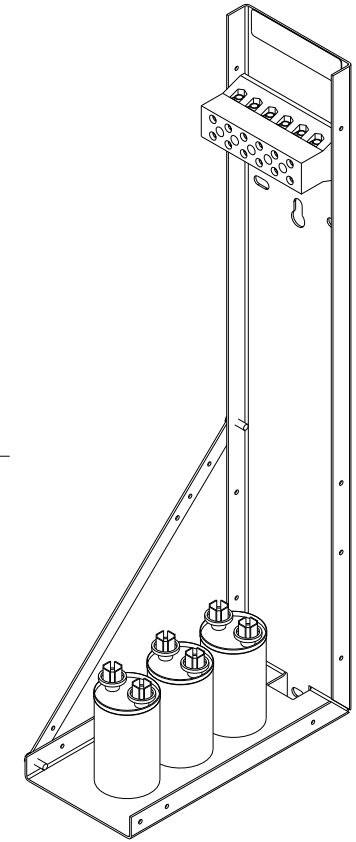
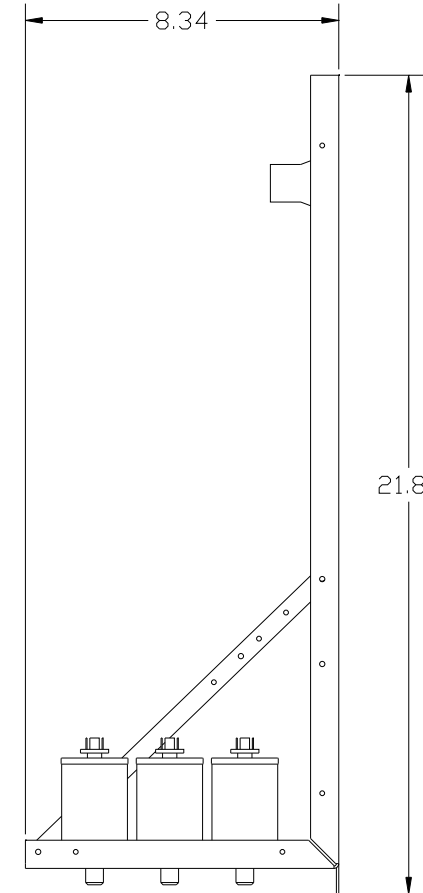
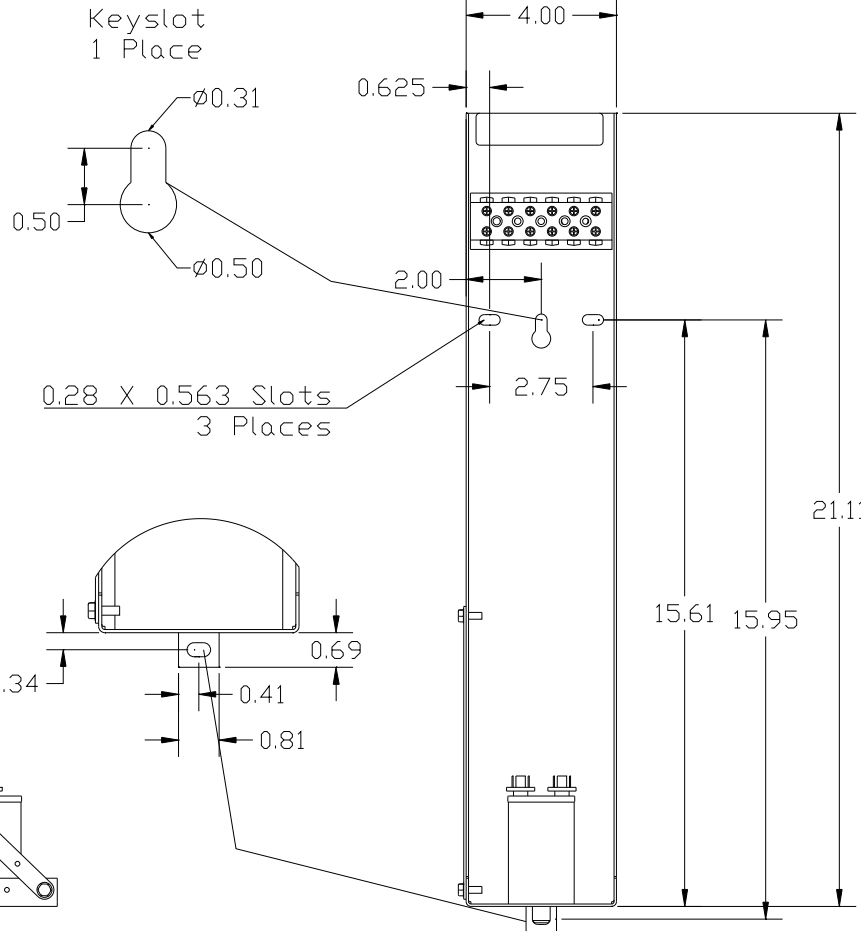
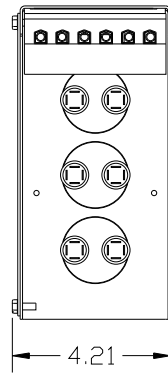

NOTE: 27908, Manual KPC Installation Guide
 MUST SHIP WITH EACH ASSEMBLY.

TOLERANCES (EXCEPT AS NOTED): DECIMAL .XX ± .03 FRACTIONAL ± 1/32 ANGULAR ± 1/2°				W132 N10611 Grant Drive Germantown, WI 53022	
				KPCUL003A60 7.5HP, 10HP, 3kVar. PANELIZED CAPS	
C	CAP. CHG	5/27/14	BMZ	DRN BY	DSW
B	2805 UPDATE BRACKET	1/9/12	DSW	DATE	8/22/11
Δ	AS BUILT	10/1/11	DSW	DATE	8/22/11
NO	REVISION	DATE	BY	SCALE	TO FIT
				Dwg No C 104784DG SHT. 1 of 1	