

GENERAL PURPOSE, 1/3R, COLOR: WHITE.

GROUND LUG 280 LBS : APPROX WEIGHT.
 WIRE RANGE: 2/0-#6 AWG
 TORQUE: 120 LB-IN

PART NUMBER: KMG130CG3R0000
 FOR SCHEMATIC SEE DRAWING# 26941.

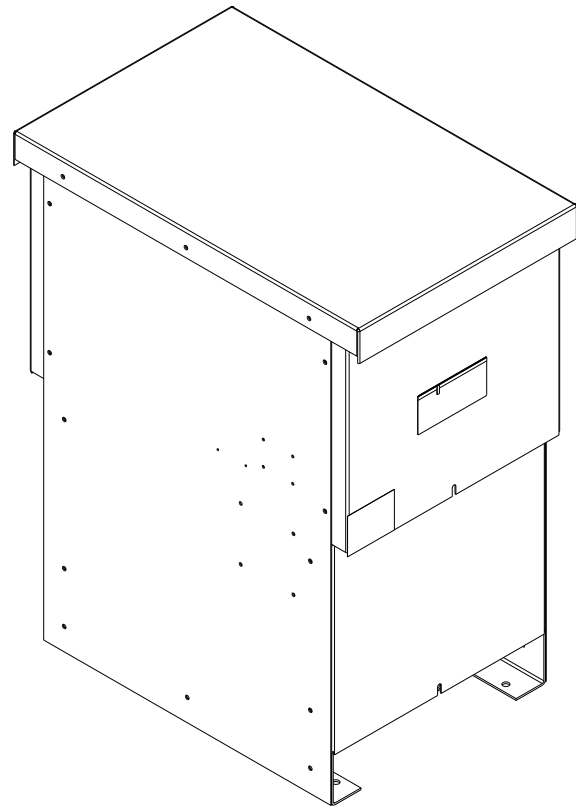

KMG HIGH PERFORMANCE OUTPUT FILTER
 PART NUMBER: KMG130CG3R0000
 FLA: 130 DRAWING#: 103926DG
 SYSTEM VOLTAGE: 600V SCHEMATIC: 26941
 HZ: 80
 PHASE: 3 ENCLOSURE TYPE: 1/3R
MOTORGUARD

CUSTOMER CONNECTIONS
 (.28 DIA HOLES 6 PLACES.)

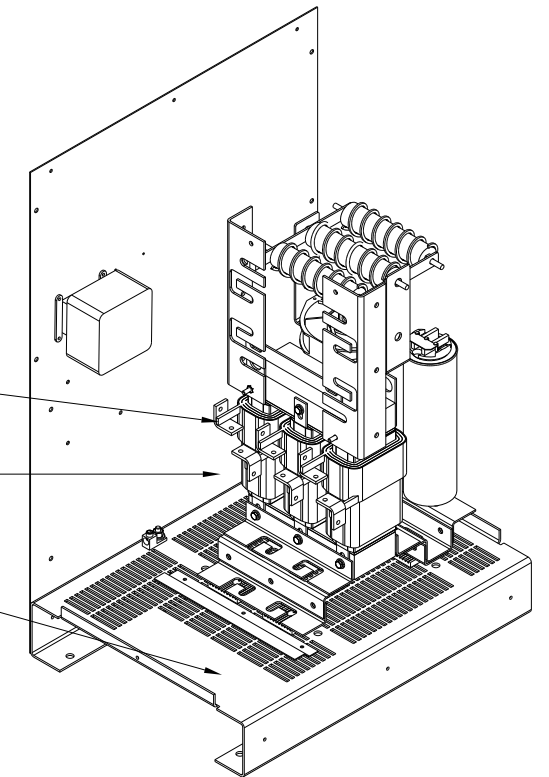
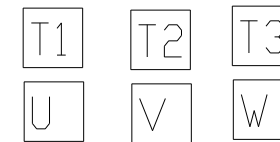

CUSTOMER WIRE ENTRANCE
 AND EXIT LOCATION.



PRIMARY FUSES .80_AMPS
 CLASS CC TIME DELAY

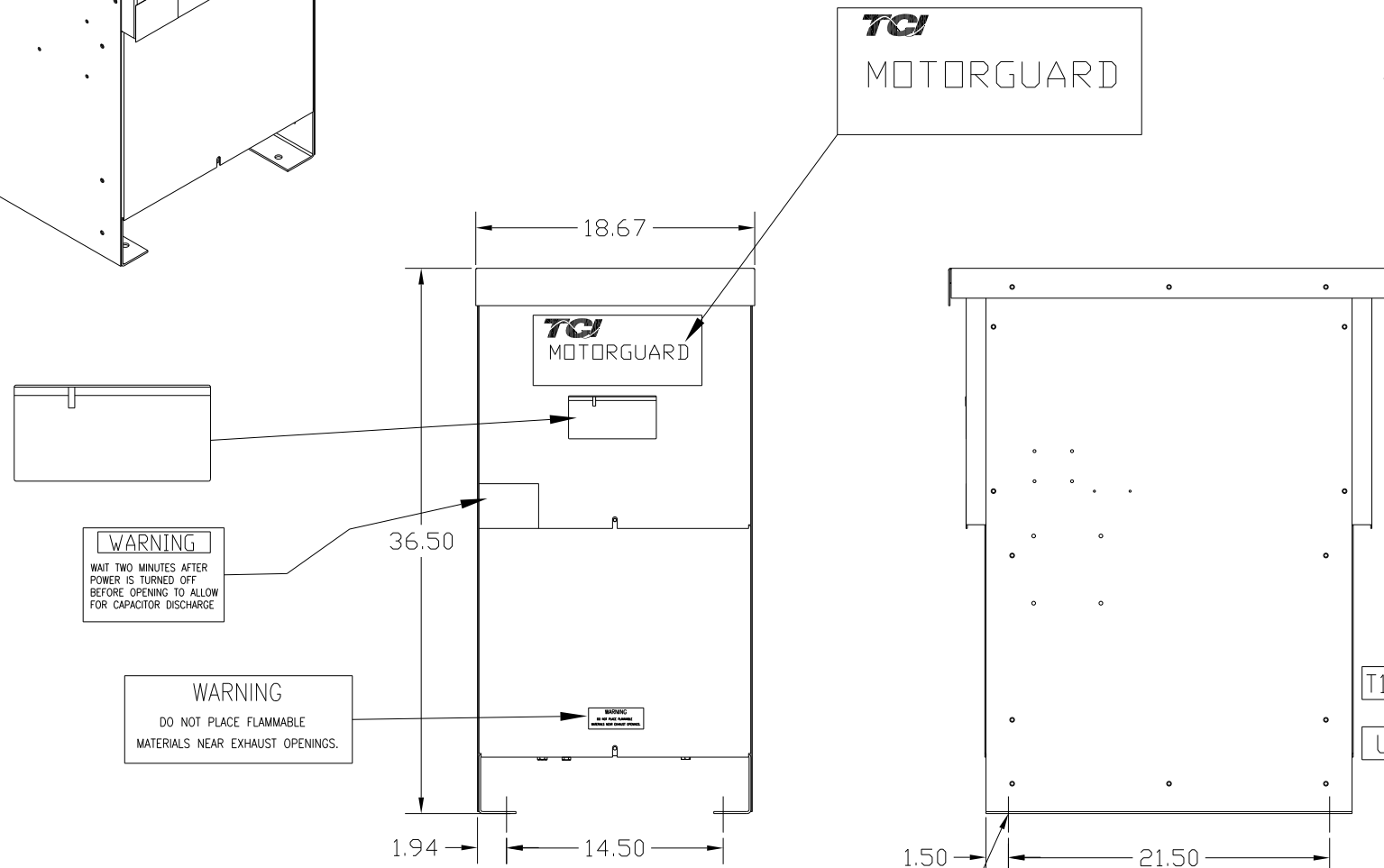

WARNING
 WAIT TWO MINUTES AFTER
 POWER IS TURNED OFF
 BEFORE OPENING TO ALLOW
 FOR CAPACITOR DISCHARGE

WARNING
 DO NOT PLACE FLAMMABLE
 MATERIALS NEAR EXHAUST OPENINGS.

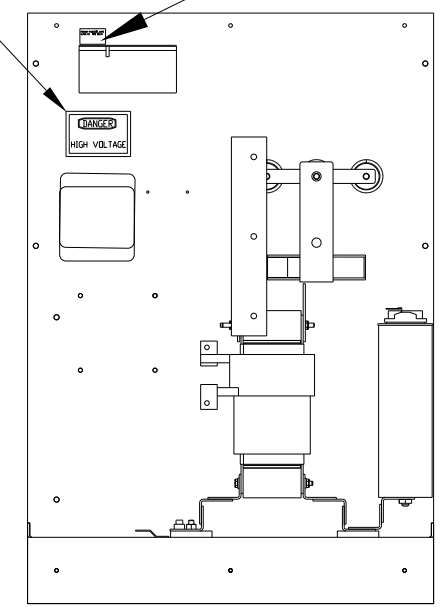
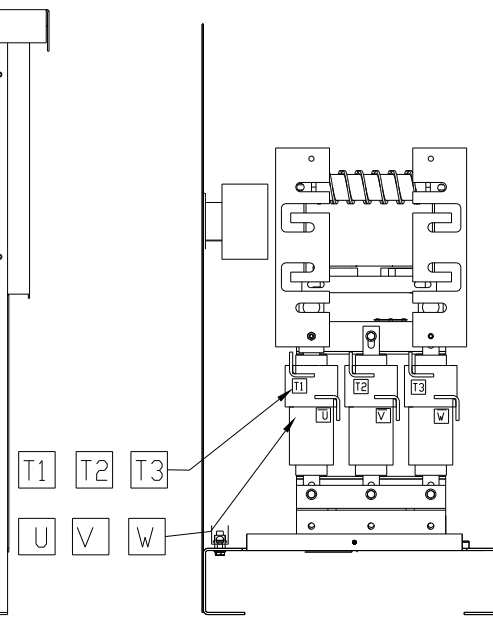

.56 DIA HOLES
 4 PLACES.

CUSTOMER IS RESPONSIBLE FOR INSTALLATION
 TO MEET ALL NATIONAL AND LOCAL ELECTRICAL CODES.

				TOLERANCES (EXCEPT AS NOTED)	TGI 7878 N. 86th STREET MILWAUKEE, WI 53224
				DECIMAL	
				.XX ± .03	KMG, LRC FILTER STANDARD 130 AMP 600/3/80, 1/3R
				.XXX ± .01	
				FRACTIONAL ± 1/32	
				ANGULAR ± 1/2°	DRN. BY DSW DATE 02/05/09 DWG. NO. 103926DG
NO	REVISION	DATE	BY	SCALE TO FIT	APPRVD. C SHT. 1 OF 1