

CATALOG NO	VOLTS(V.)	_mH±10%	_AMPS(A)	APPROX WT-LBS
KLRUL200CPT01	24.00	.184	200	182

CATALOG NO	VOLTS(V.)	_mH±10%	_AMPS(A)	APPROX WT-LBS
KLRUL200EPT01	28.75	.220	200	182

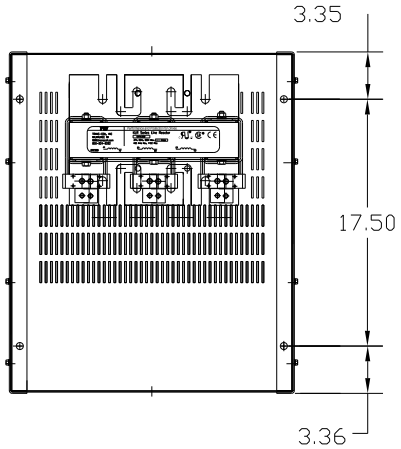

LUG WIRE RANGE 250MCM-6, AL OR CU.
FOR REACTOR.
TIGHTENING TORQUE. 275 LB-IN



LABEL PLACED ON FRONT OF CABINET.



LABEL PLACED ON INSIDE WALL OF CABINET.

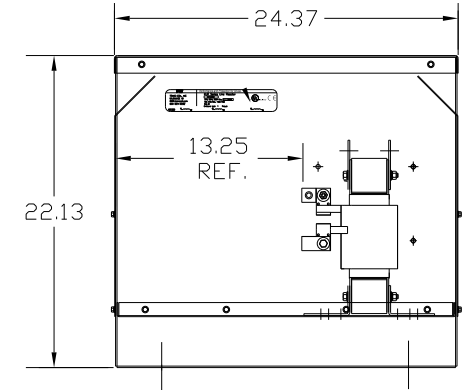
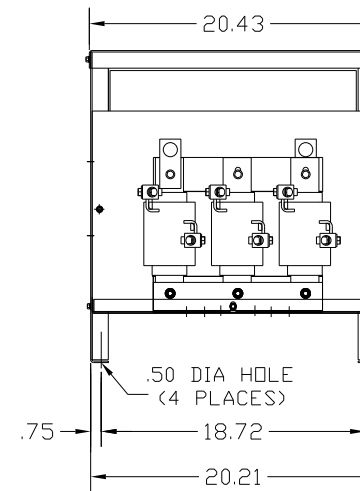
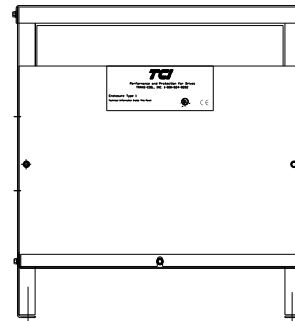
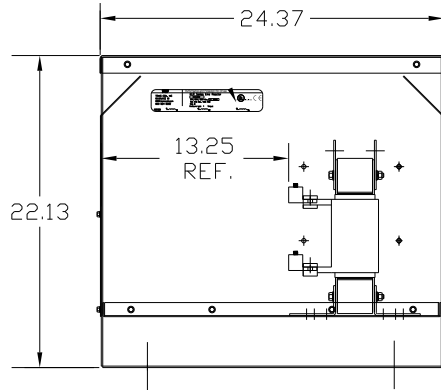
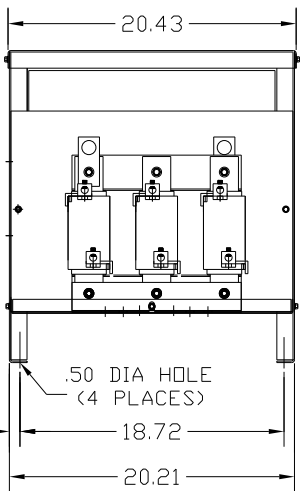
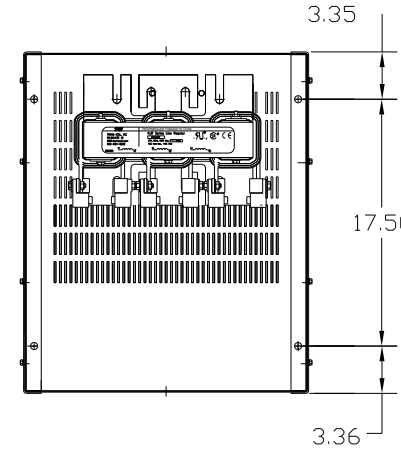

CUSTOMER IS RESPONSIBLE FOR INSTALLATION
TO MEET ALL LOCAL AND NATIONAL CODES

VENDOR LILLY POWDER COATINGS, INC.
PRODUCT CODE 312E
COLOR PEBBLE GRAY
POWDER TYPE POLYESTER POLYURETHANE

PAINT SUITABLE FOR OUTDOOR APPLICATION PER UL TYPE 3R
AND APPLIED PER A UL ACCEPTED DTW2 COATING PROGRAM.

		TOLERANCES (EXCEPT AS NOTED)	
		DECIMAL	
		.XX ±.03	
		.XXX±.01	
		FRACTIONAL	
		± 1/32	
		ANGULAR	
		± 1/2°	
NO	REVISION	DATE	BY
2908	UPDATE 200EPT	3/19/13	DSW

TCI 7878 N. 86th STREET
MILWAUKEE, WI 53224

KLR FRAME L (ILSCO LUGS)
TYPE 1 ENCLOSURE

DRN. BY	DATE	DWG. NO.
DSW	12/08/03	KLRULENCL-18DG
SCALE	APRVD.	SHT.1 OF1
TO FIT		