

TCI PART#	AMPS (A)	--mH±10%	APPROX WT-LBS
KLR360CCB	360	.102	156

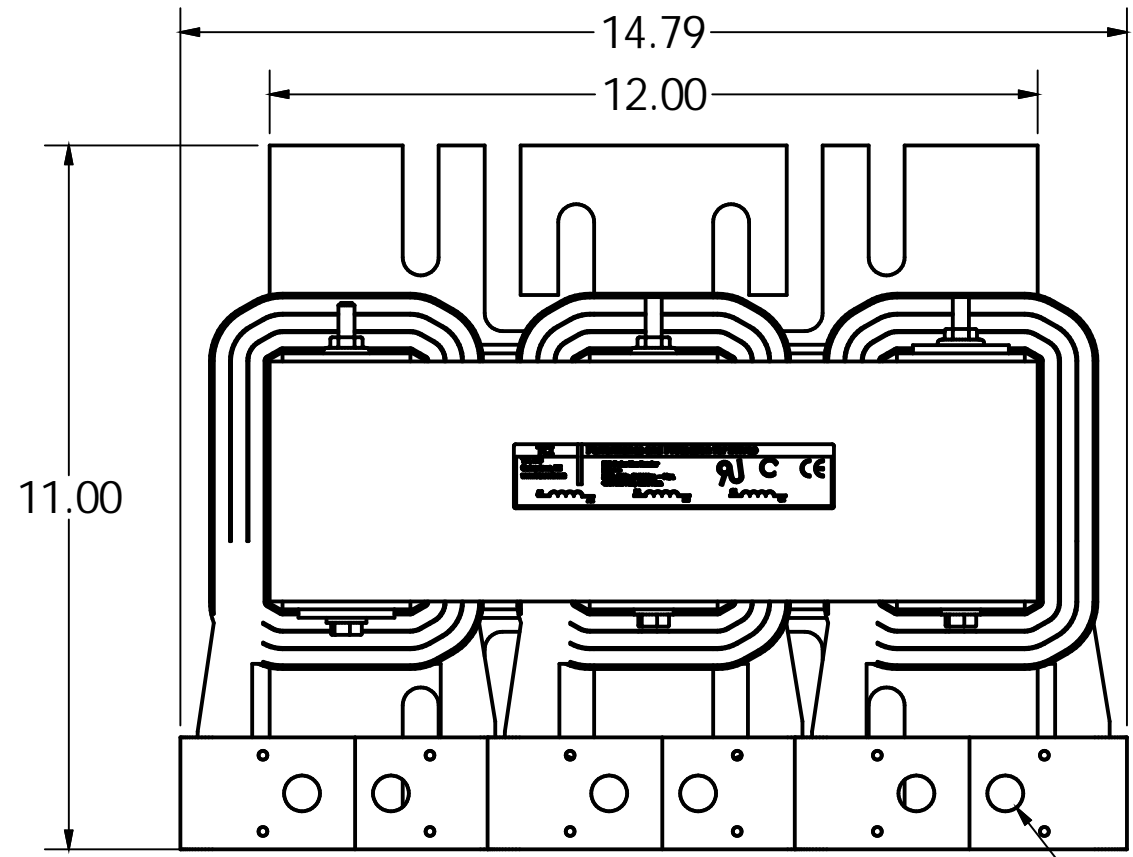

0.56 DIA HOLES  
6 PLACES

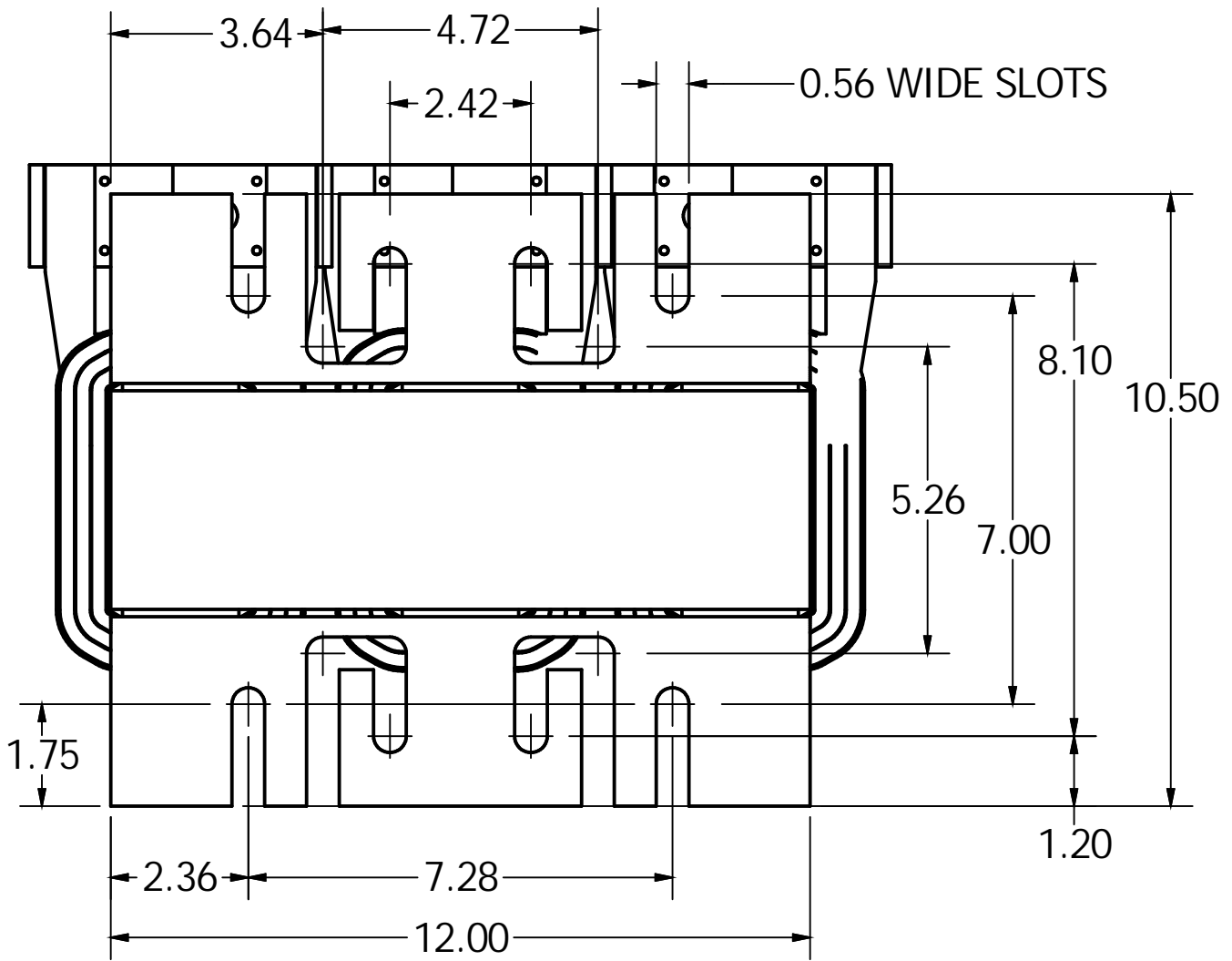
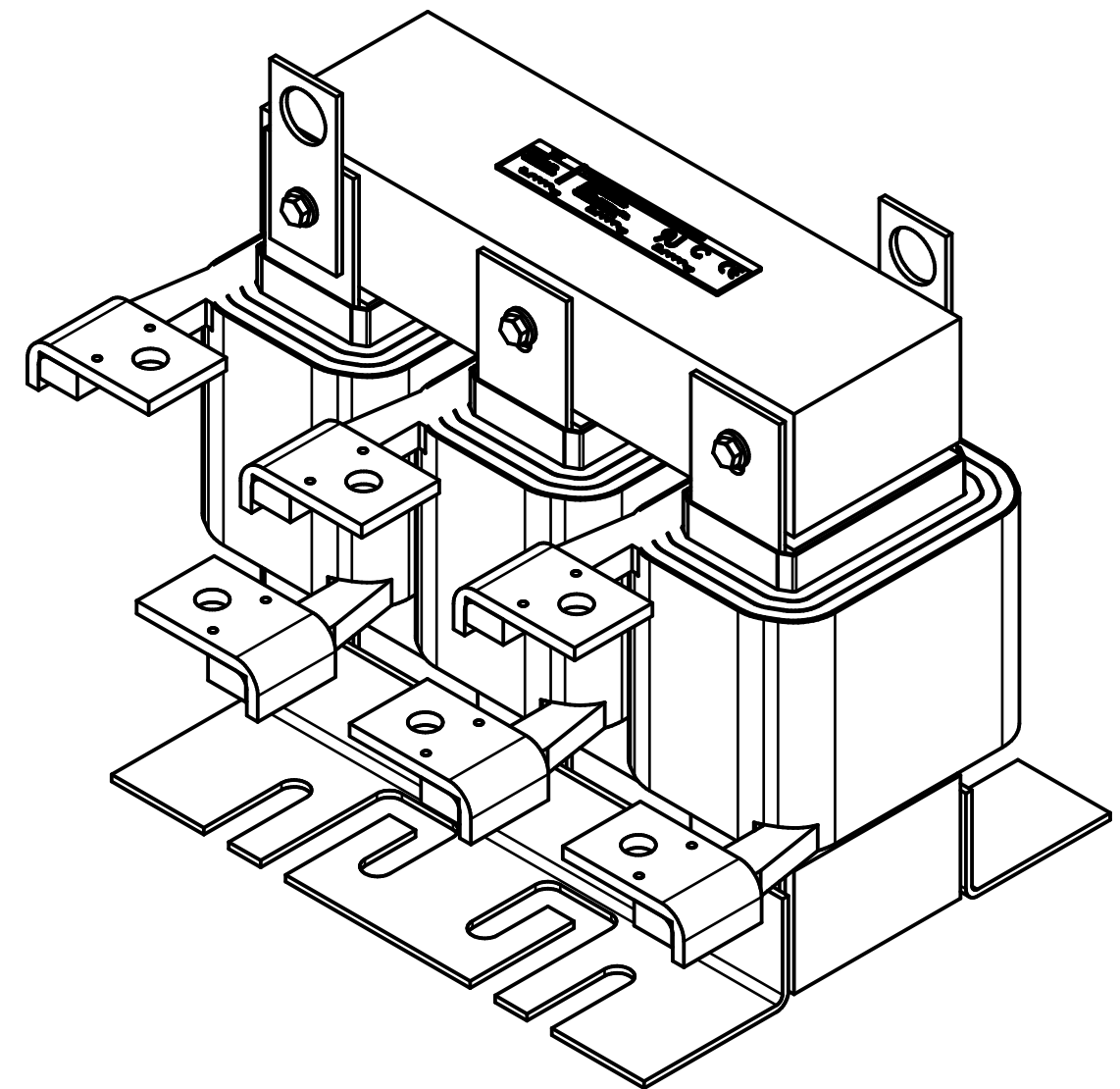
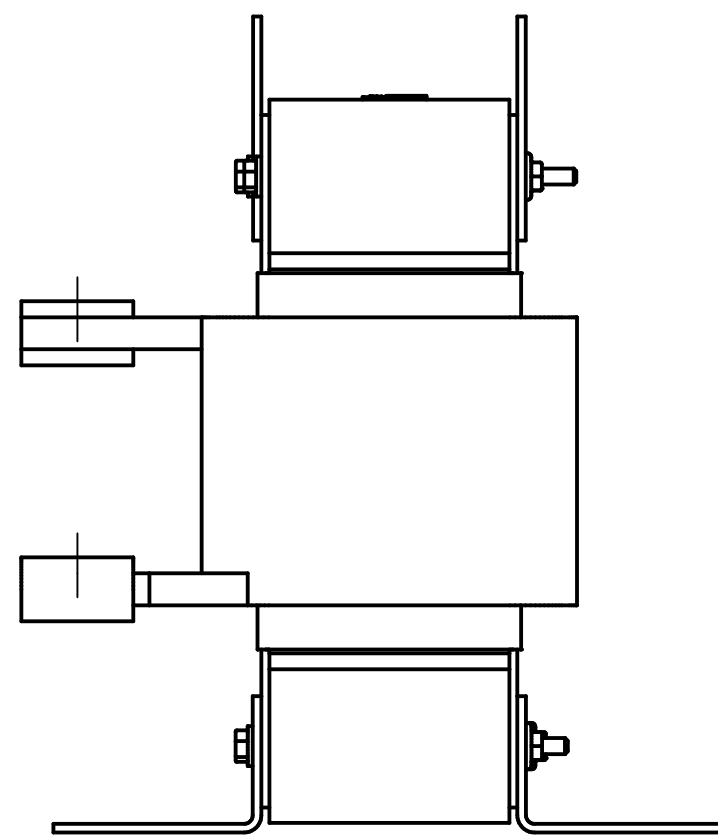
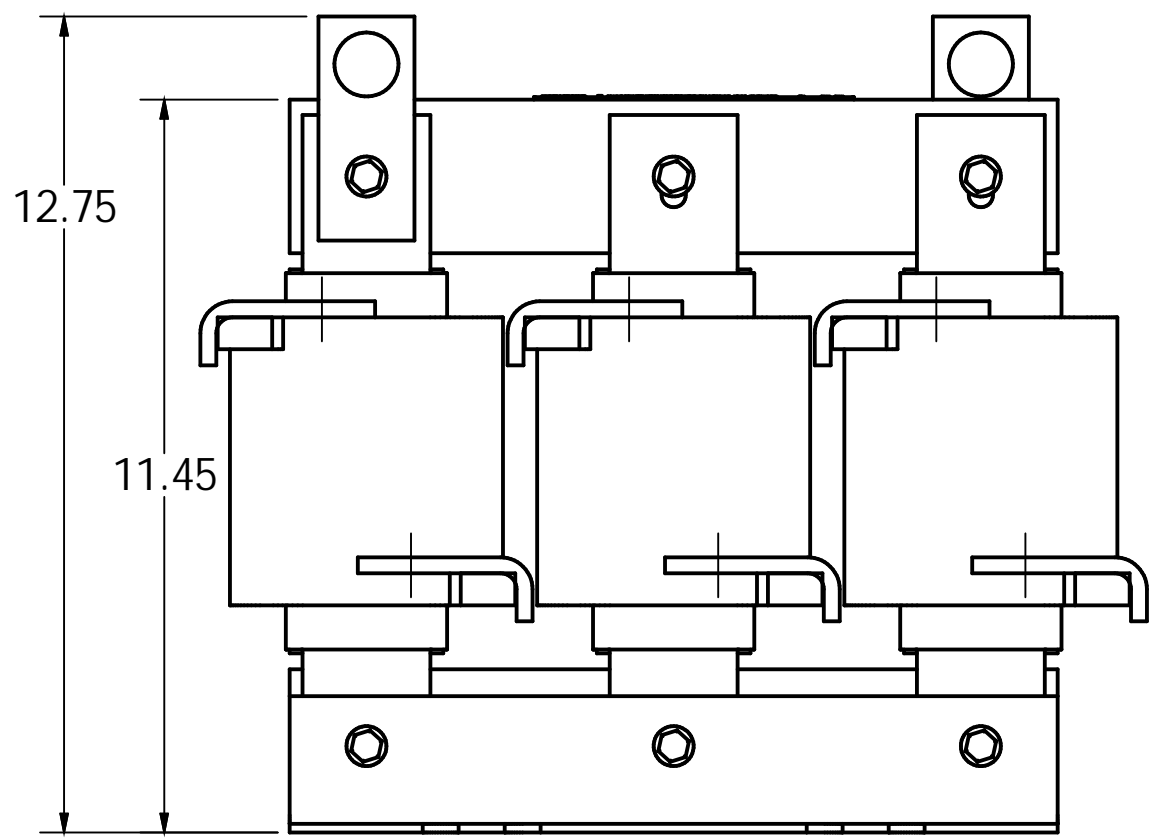

NO	REVISION	DATE	BY	TOLERANCES (EXCEPT AS NOTED)	<b>W132 N10611 Grant Drive Germentown, WI 53022</b>  <b>SINEGUARD REACTOR KLR CB'S (FRAME S)</b>	<small>DRN. BY</small> BW <small>SCALE</small> 1/3	<small>DATE</small> 4/01/98 <small>APPRVD.</small>	<small>DWG. No.</small> <b>KLR-31DG</b> <small>SHEET 1 OF 1</small>
C	3454-1 REVISED HEIGHT DIM	12/8/15	DSW	DECIMAL .XX +/- .25 .XXX +/- .1				
B	3454 UPDATE DRAWING	11/25/15	DSW	FRACTIONAL +/- 1/16				
A	AS DESIGNED	6/03/03	DSW	ANGULAR +/- 1°				