

HP	CATALOG NO	_AMPS(A)	APPROX WT-LBS
500	KDRX5TT	590	285

TCI Performance and Protection for Drives.

TRANS-COIL, INC
MILWAUKEE, WI
WWW.TRANS-COIL.COM
800-524-9292

KDR Drive Reactor
REACTOR Motor Amps Max
3PH, 480V, 600V Max A Bypass
400 Amp Max, 150C Rise

UL US CE

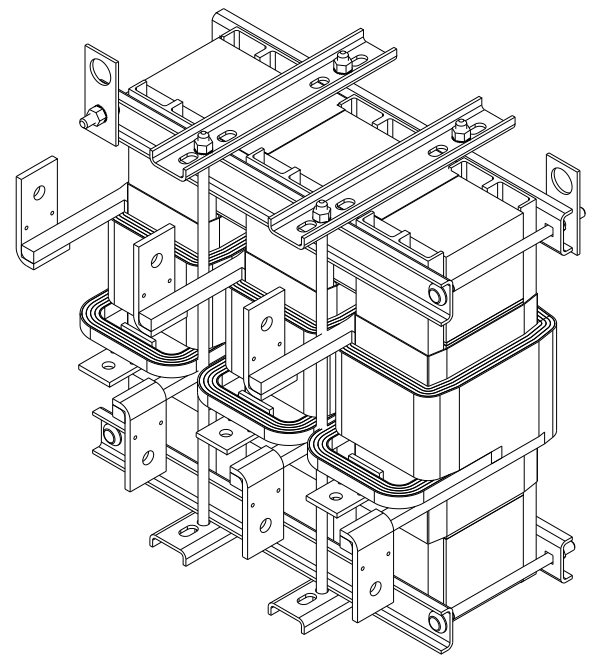
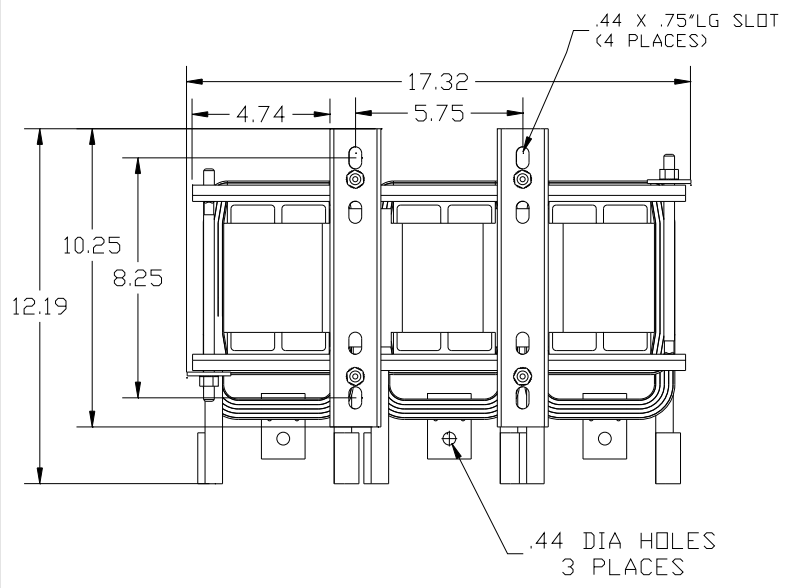

A1, AT, A2, B1, BT, B2, C1, CT, C2, MARKINGS FOR REFERENCE ONLY

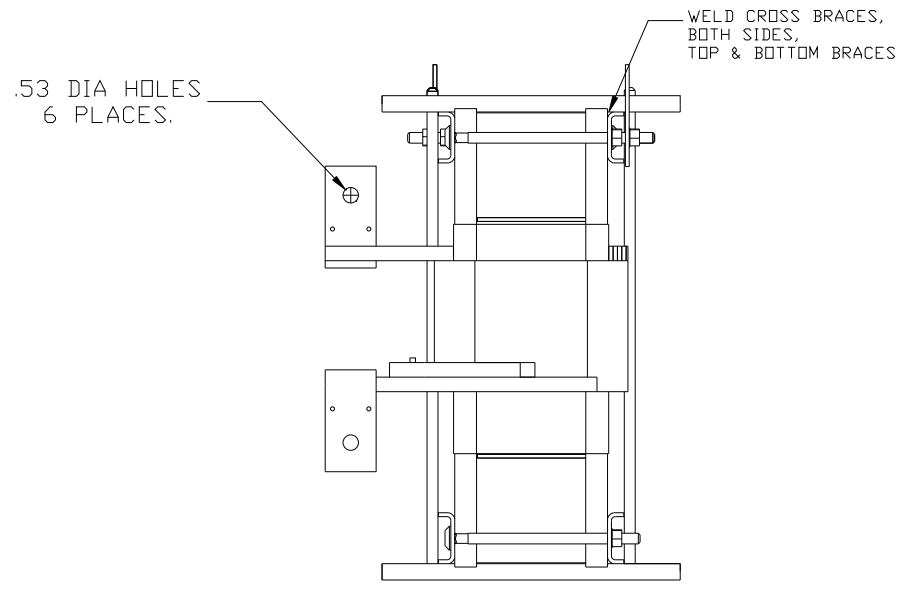
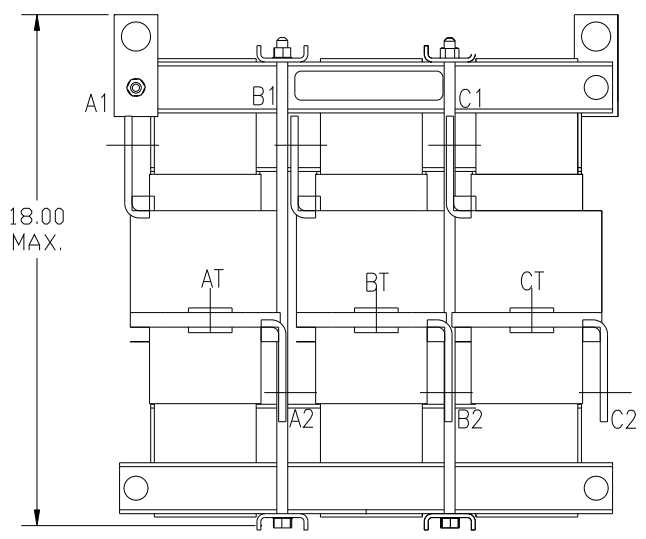

			TOLERANCES (EXCEPT AS NOTED)	TCI 7878 N. 86th STREET MILWAUKEE, WI 53224	
			DECIMAL		
			.XX ± .03	KDRX5TT 500HP HGP FILTER REACTOR	
			.XXX ± .01		
			FRACTIONAL	DRN. BY DSW DATE 6/6/2013 DWG. NO. 105289DG	
			± 1/32		
A CHANGE TAP PLACEMENT			ANGULAR	SCALE TO FIT	
NO REVISION		DATE	BY		APRVD
		7/2/13	DSW		SHT. 1 OF 1