

Unit Specifications					
kVar	Harmonic	Volt	HZ.	Phase	HP
90	5TH	600	60	3	600

TCI Part Number	Option	Weight	Schematic
HGL0600CW3S0000	Standard	1175lbs	30807-S
HGL0600CW3C0000	Contactor	1195lbs	30807-C

See IOM Manual For Wire Range
And Tightening Torque.

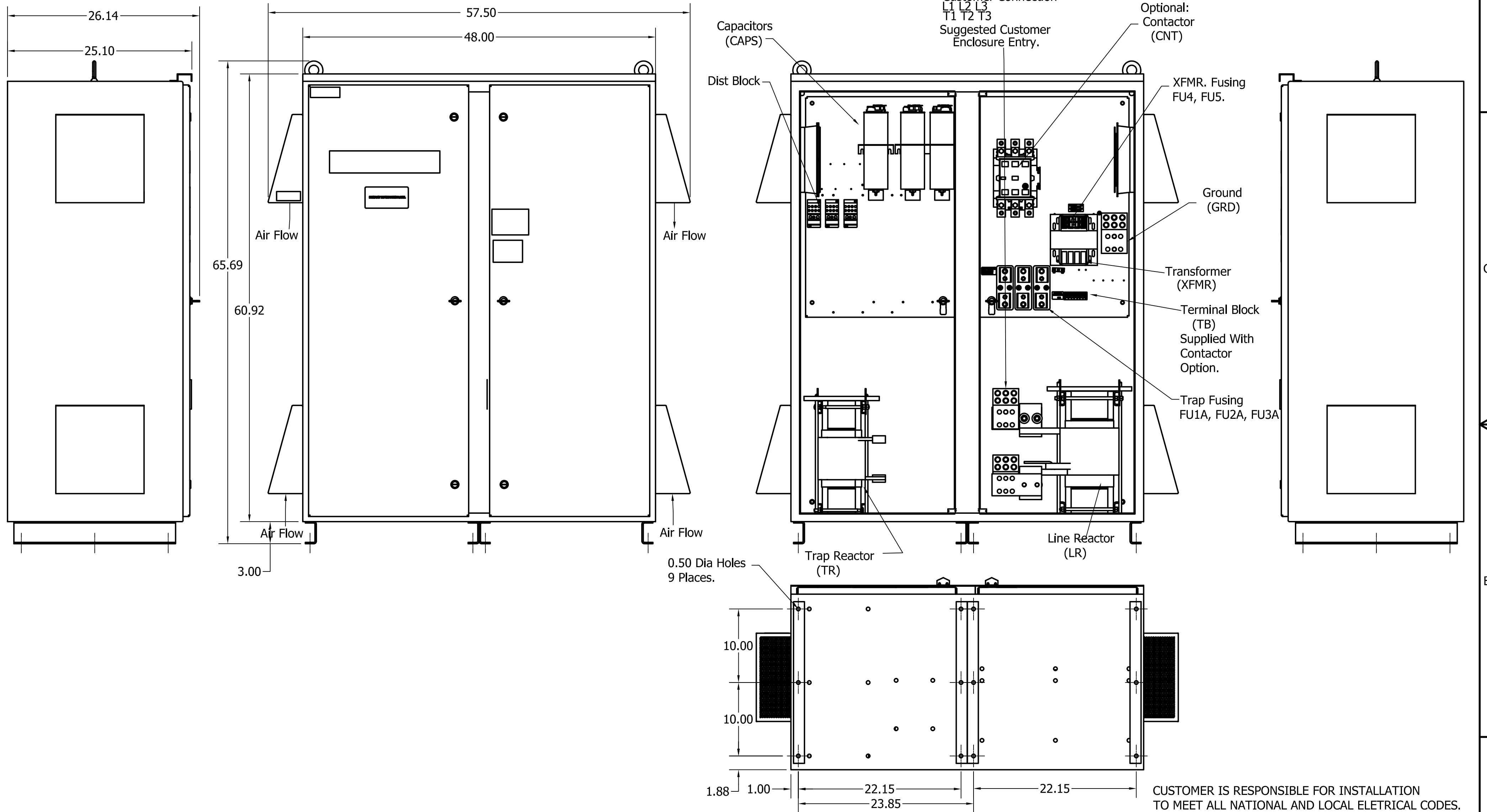

CUSTOMER IS RESPONSIBLE FOR INSTALLATION
TO MEET ALL NATIONAL AND LOCAL ELETTRICAL CODES.

NOTE: USE ONLY HUBS OR FITTINGS THAT COMPLY
WITH UL514B FOR TYPE 3R ENCLOSURES

Material(s) Shall be RoHS Compliant

TCI, LLC CLAIMS PROPRIETARY RIGHTS IN THE MATERIAL HEREIN DISCLOSED. IT IS SUPPLIED WITHOUT PREDJUDICE TO ANY PATENT RIGHTS OF TCI AND MAY NOT BE REPRODUCED OR USED TO MANUFACTURE ANYTHING SHOWN THEREIN WITHOUT WRITTEN PERMISSION FROM TCI.

NO	REVISION	DATE	BY	SCALE
A	AS DESIGNED	10/12/17	DSW	ANGULAR +/- 1°

	W132 N10611 GRANT DRIVE GERMANTOWN, WI 53022
	HGL0600CW3C0000, 600V, 600HP, 3 Phase HGL0600CW3S0000, 600V, 600HP, 3 Phase 60 Hz, Type 3R, Low C, Passive Harmonic Filter
	DRN. BY: DSW DATE: 10/12/17 SCALE: 1/8 DWG. No.: 107318DG SHEET 1 OF 1

4 3 2 1

4 3 2 1

D
C
B
A

D
C
B
A