

Assembled Views

1/2 Scale

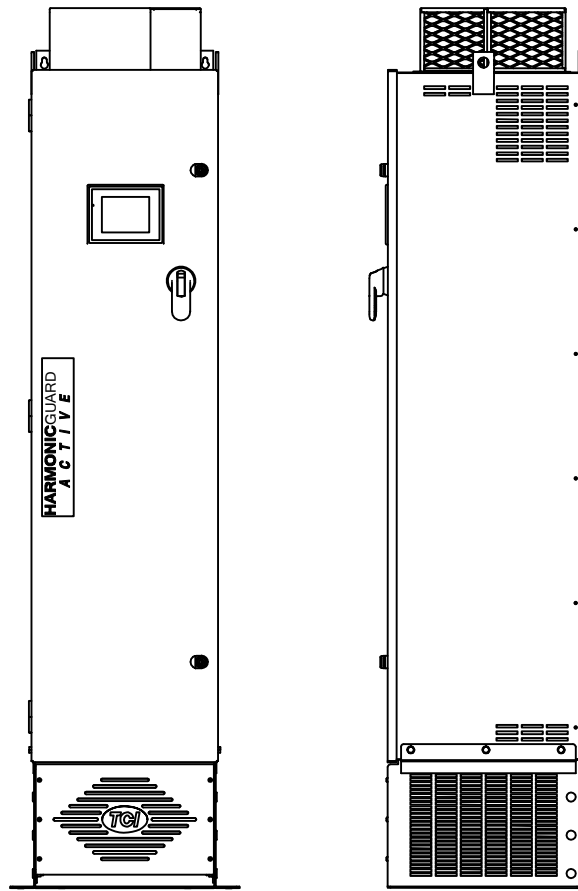

See Note 10

Laying On Back

See Notes 1 & 2

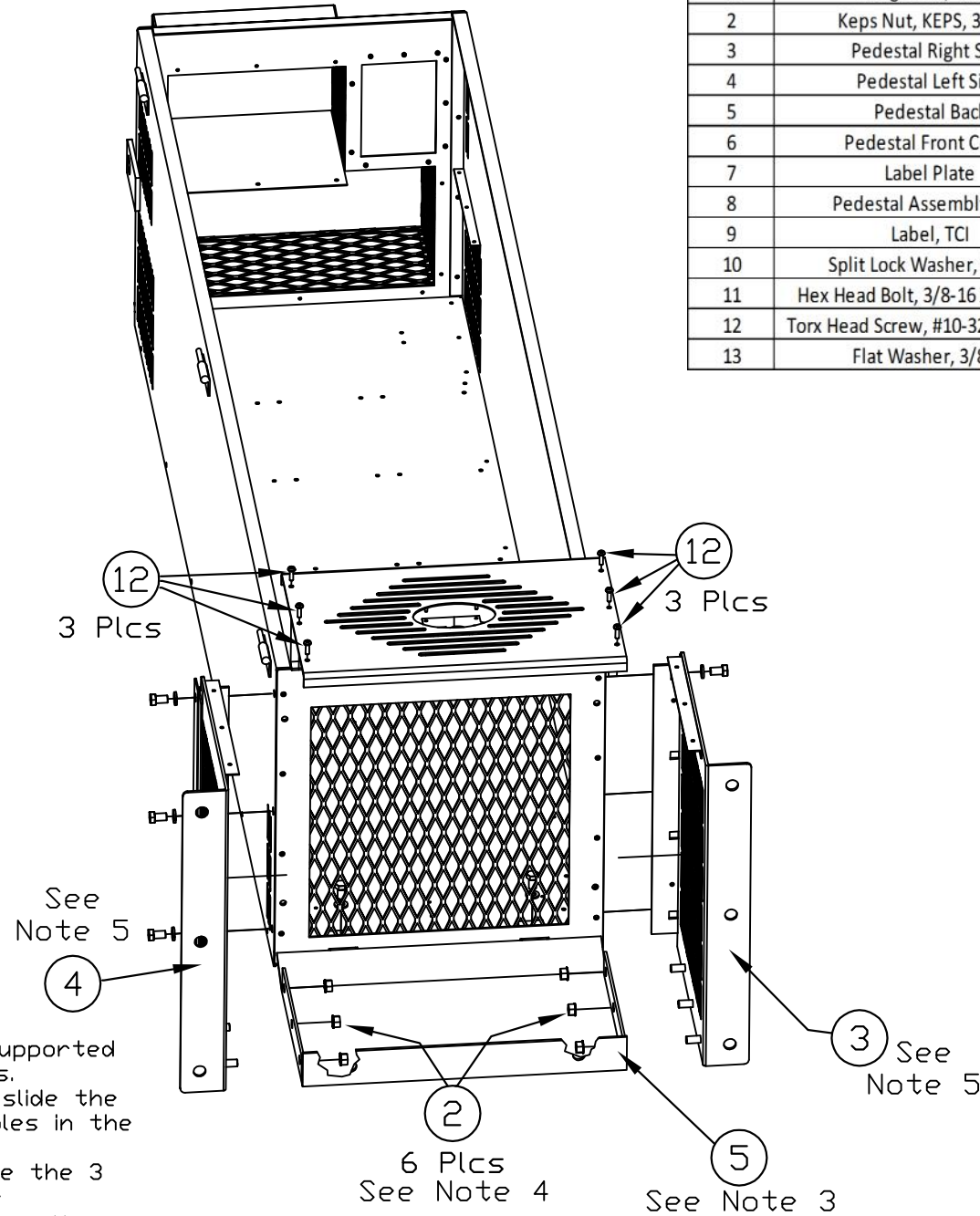

Parts List			
Item Number	Part Description	Qty	TCI Part Number
1	Flange Nut, #6-32	4	3103
2	Keps Nut, KEPS, 3/8-16	6	11626
3	Pedestal Right Side	1	29190
4	Pedestal Left Side	1	29191
5	Pedestal Back	1	29192
6	Pedestal Front Cover	1	29194
7	Label Plate	1	29199
8	Pedestal Assembly Dwg	1	29252
9	Label, TCI	1	29256
10	Split Lock Washer, 3/8 IN	8	1556
11	Hex Head Bolt, 3/8-16 X 3/4 Long	8	1782
12	Torx Head Screw, #10-32 X 5/8 Long	6	24826
13	Flat Washer, 3/8 IN	2	11841

Right Side View

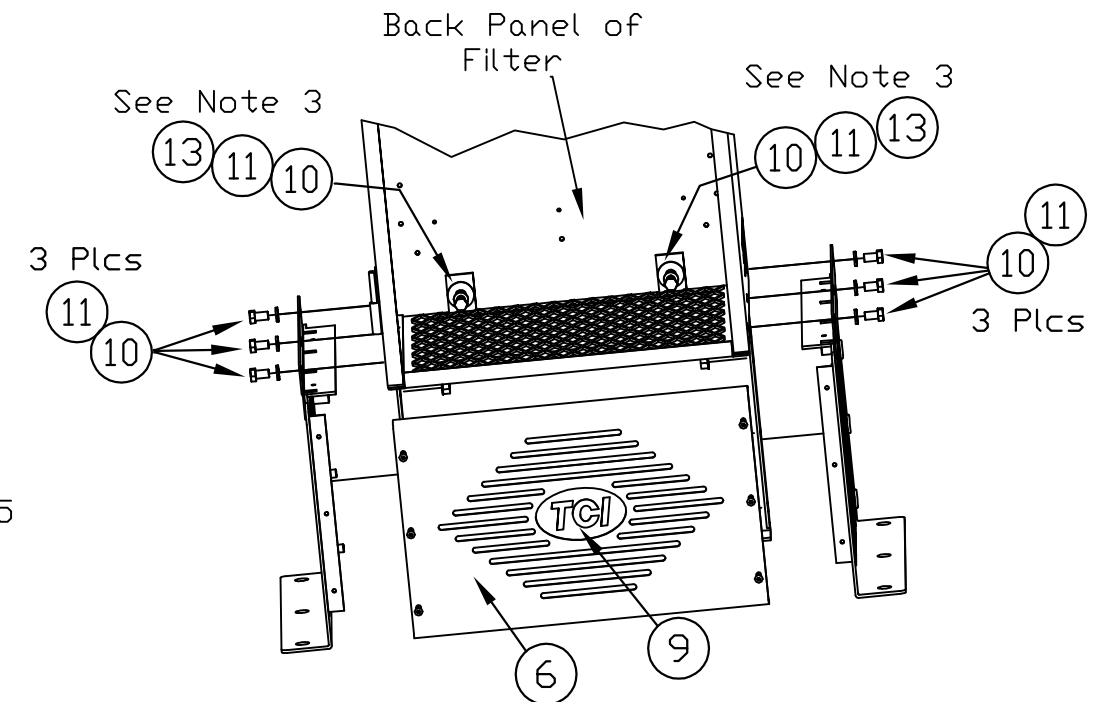
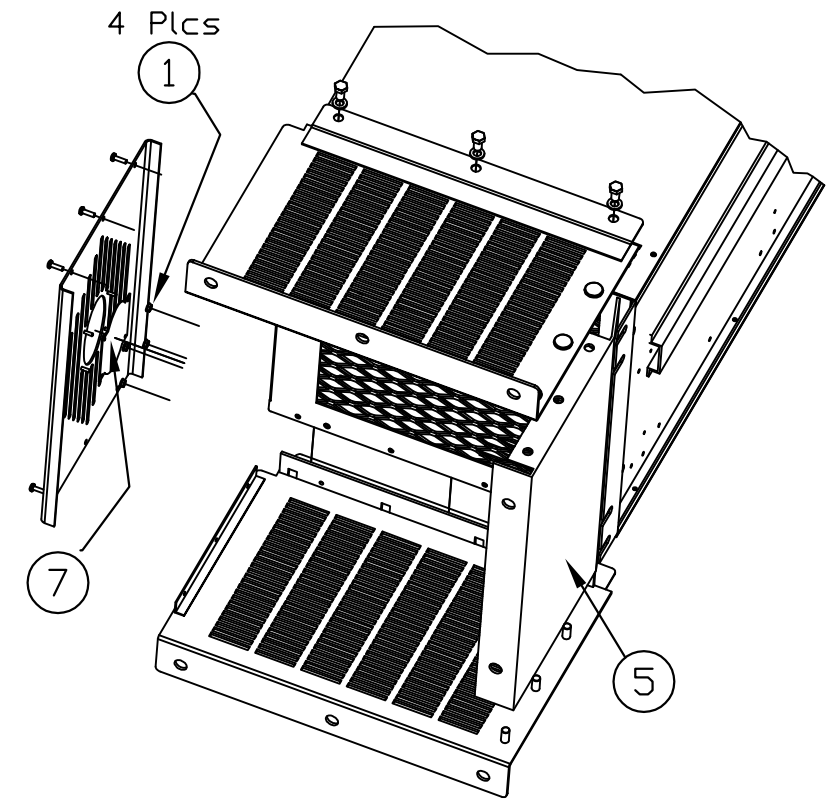

Front View

Assembling Instructions:

- 1.) Lay the enclosure/filter on its back.
- 2.) Open the doors. **CAUTION**, the open doors should be supported so the weight of the doors aren't hanging on the hinges.
- 3.) Place the pedestal back #5 on a flat surface, then slide the right & left (#3 & 4) pedestal side studs through the holes in the back. Loosely thread nuts #2 onto the 8 studs.
- 4.) Lift with two hands the assembled sides/back and slide the 3 tabs of the pedestal back #5 through the slots on the enclosure bottom. Secure it to back panel with 3/8 hardware item #'s 10, 11 & 13.
- 5.) Secure the pedestal sides to the enclosure sides with 3/8 inch bolts #11 and lock washer #10.
- 6.) Only finger tighten all 3/8 inch hardware for the sides and back. Once in place, then torque all 3/8 hardware to 250 in. lb.
- 7.) Carefully stand filter up and move into place using the lifting eyes located the top of the enclosure. **WARNING: TIPPING HAZARD, assembled unit has high center of gravity, extreme care should be used until the filter is properly anchored to the floor.**
- 8.) Anchor unit to floor using the three holes located on each side of the pedestal; refer to installation drawing #105763.
- 9.) Place label #9 on lable plate #7. Use nuts #1 to mounting plate on inside of front cover.
- 10.) Install front cover using screws #12. **CAUTION**, damage can occur to cover by using any lifting devices under the front cover.
- 11.) For pedestal catalog #HGAF01E1.

WARNING: Filter must be securely anchored to the floor to avoid a tipping hazard!

TCI, LLC CLAIMS PROPRIETARY RIGHTS IN THE MATERIAL HEREIN DISCLOSED. IT IS SUPPLIED WITHOUT PREJUDICE TO ANY PATENT RIGHTS OF TCI AND MAY NOT BE REPRODUCED OR USED TO MANUFACTURE ANYTHING SHOWN THEREIN WITHOUT WRITTEN PERMISSION FROM TCI.

A	Edit Notes	11/24/14	RHW
NO	REVISION	DATE	BY

TOLERANCES (EXCEPT AS NOTED)	
DECIMAL	.XX ± .05
	.XXX ± .025
FRACTIONAL	± 1/32
ANGULAR	± 1/2°

TCI® W132 N10611 Grant Drive
Germantown, WI 53022

Pedestal Assy Dwg, Type 1
Size E1, Active Filter, 110-150 Amp

DRN. BY	RHW	DATE	11/24/14	DWG. NO.	29252
SCALE	N/A	SIZE	B	SHT. 1 OF 1	