

KPCUL066A64, 480V, 251A, 66kVar  
 Approx. Weight: 45 Lbs

Customer Input	
Wire Range	Tightening Torque
3/0-350mcm	170 Lb-In

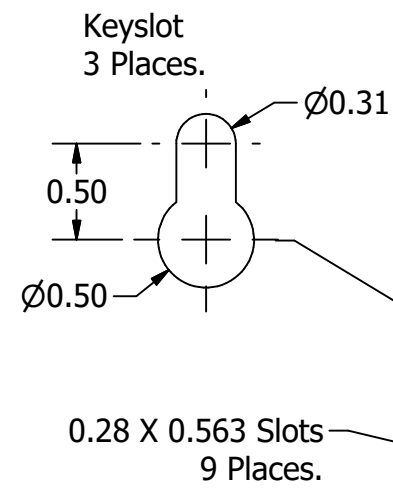

0.28 X 0.563 Slots  
 9 Places.

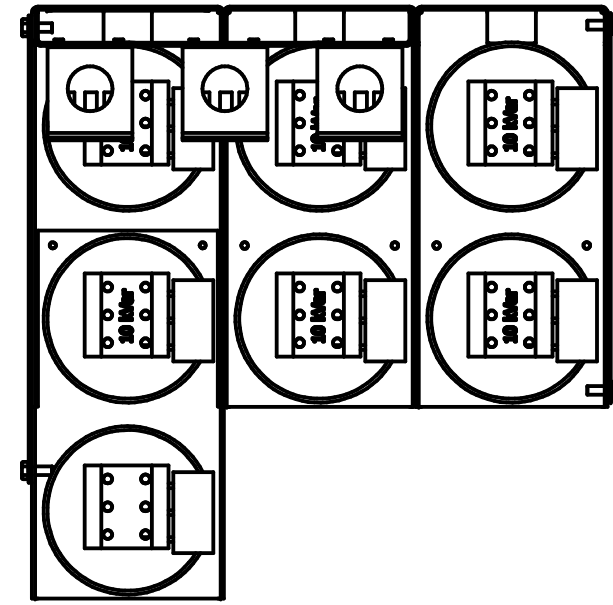
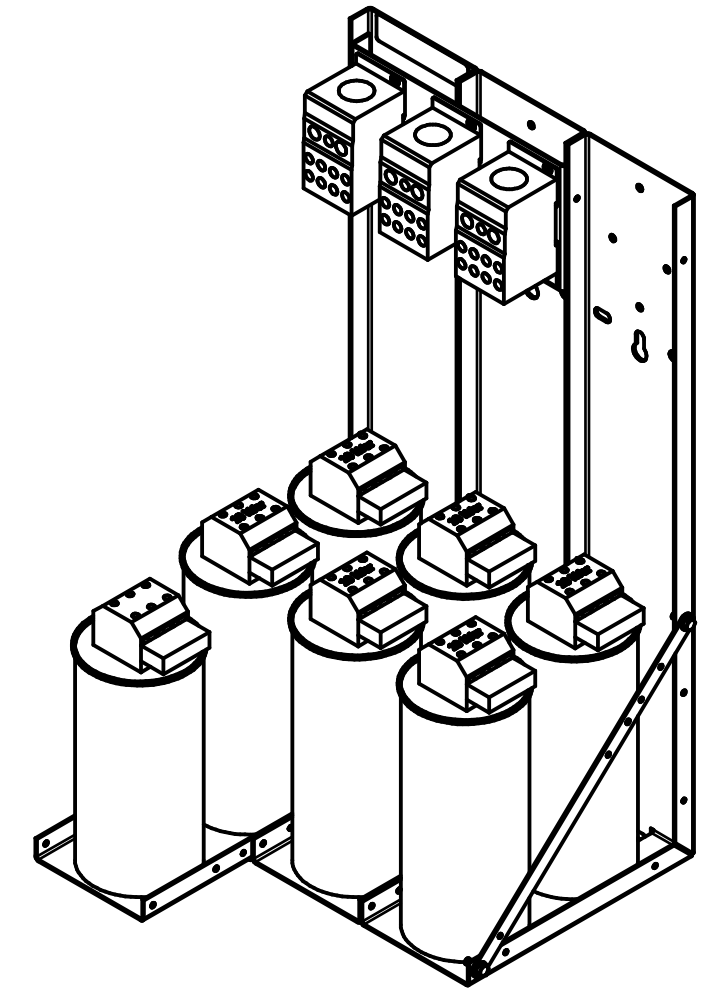
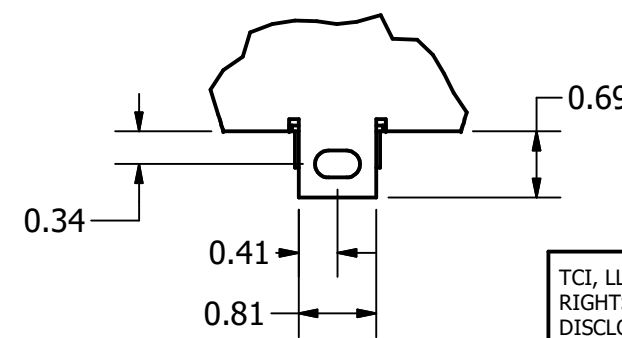
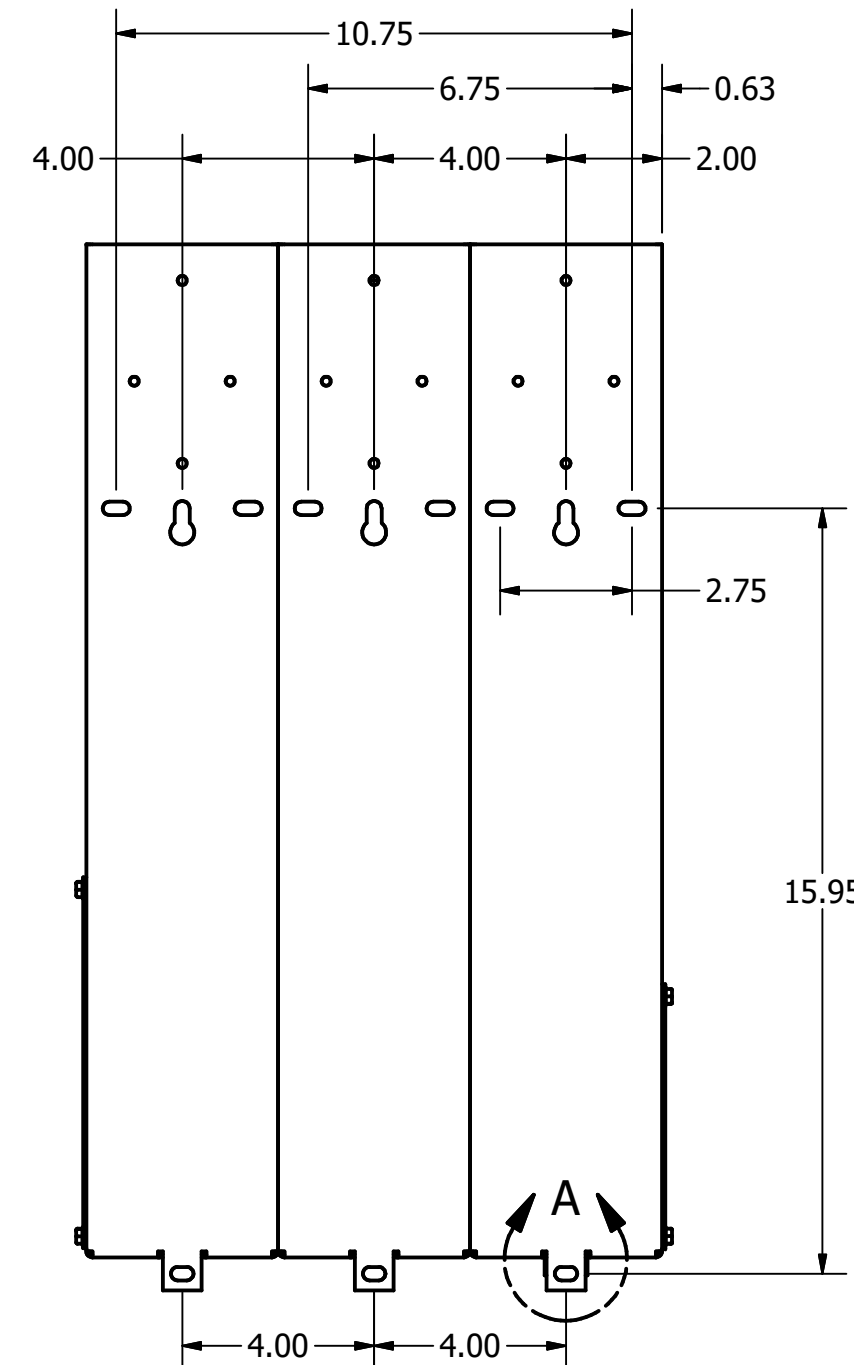
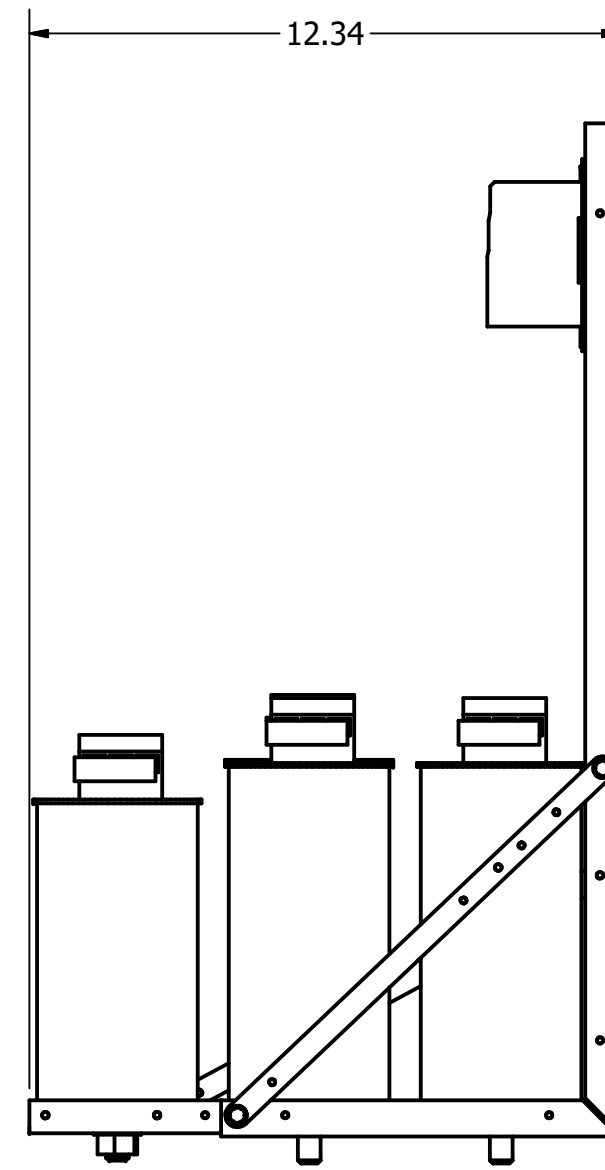
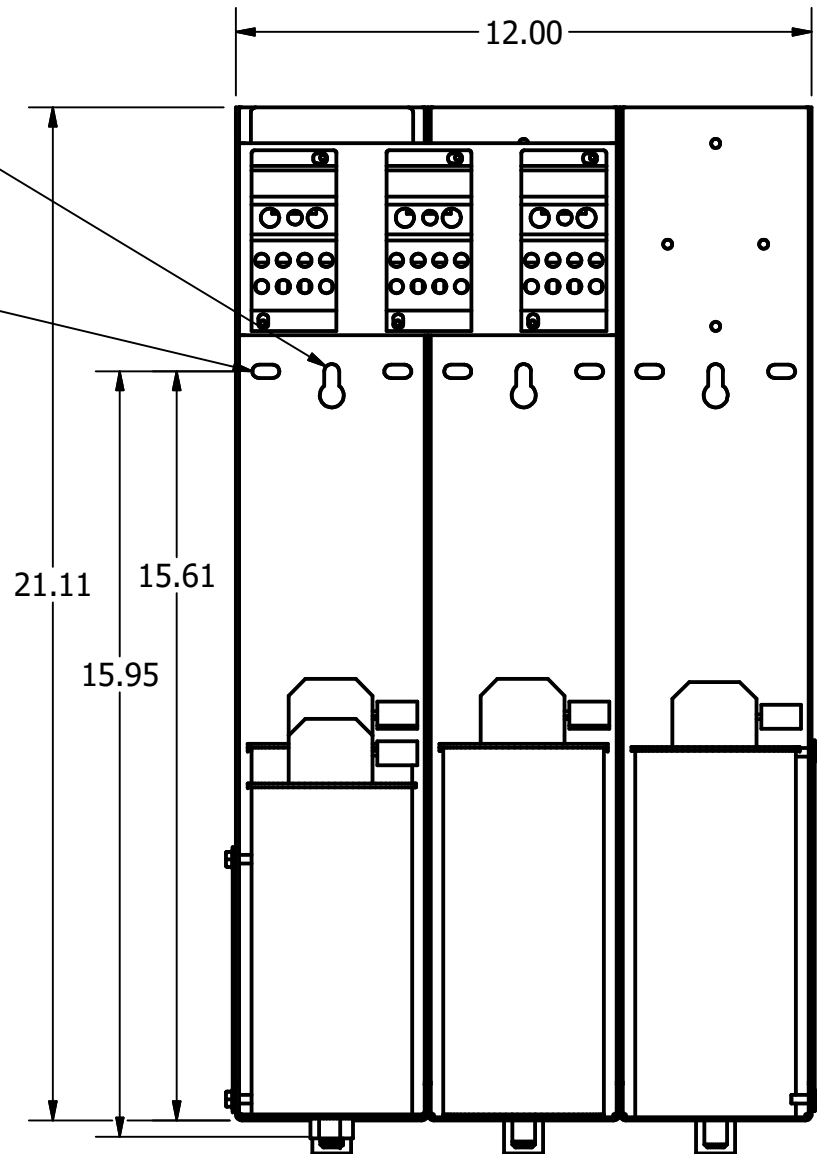
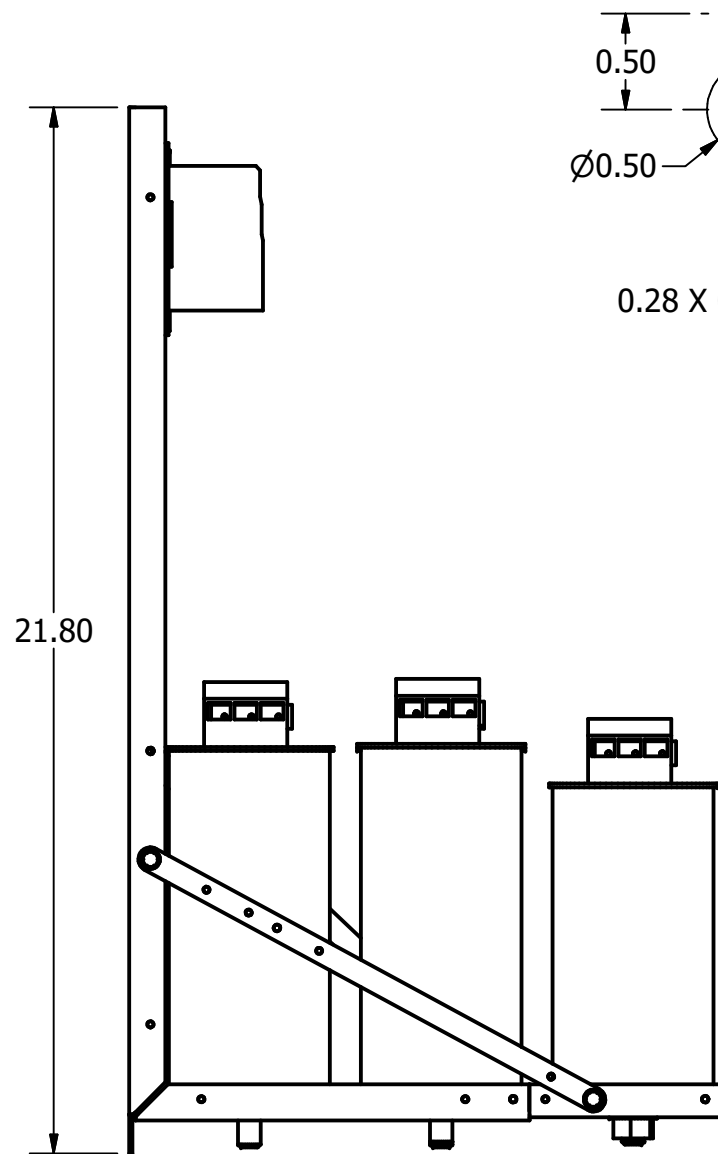

DETAIL A

HOLE TOLERANCE ± .005

TCI, LLC CLAIMS PROPRIETARY RIGHTS IN THE MATERIAL HEREIN DISCLOSED. IT IS SUPPLIED WITHOUT PREJUDICE TO ANY PATENT RIGHTS OF TCI AND MAY NOT BE REPRODUCED OR USED TO MANUFACTURE ANYTHING SHOWN THEREIN WITHOUT WRITTEN PERMISSION FROM TCI.

TOLERANCES (EXCEPT AS NOTED)			
			DECIMAL
			.XX ± .25
			.XXX ± .10
			FRACTIONAL
			± 1/16
			ANGULAR
			± 1°

**TCI** W132 N10611 Grant Drive  
 Germantown, WI 53022

KPCUL066A64, 480V, 66kVAR  
 Sinewave, Panelized Caps

DRN BY JRN	DATE 10/21/19	108330DG
SCALE	APRVD:	SIZE C

SHT. 1 OF 1

NO	REVISION	DATE	BY
A	As Designed	10/21/19	JRN