

TCI Part Number	Rated Amps (A)	Rated Voltage (V)	Hz	---uH ±5%	Approx Weight (LBS)
KTRMG160C	160	600	60	373	165

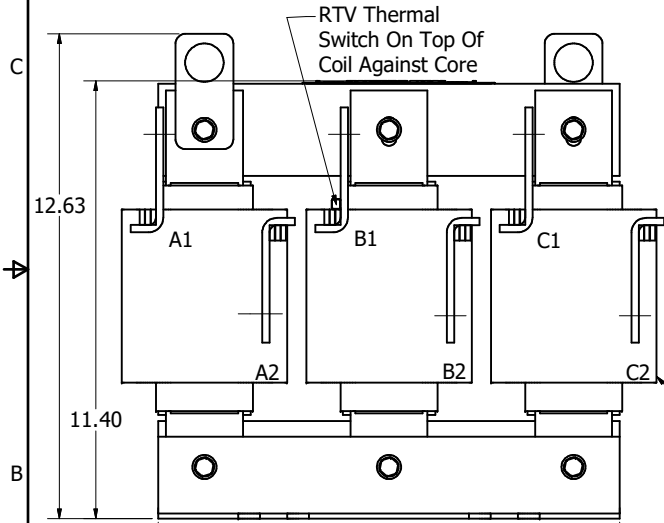

0.44 Dia Holes
6 Places

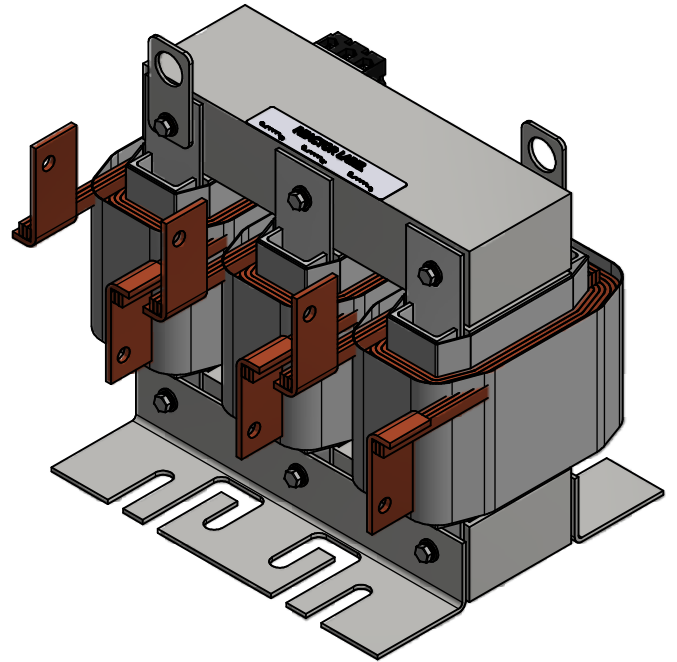
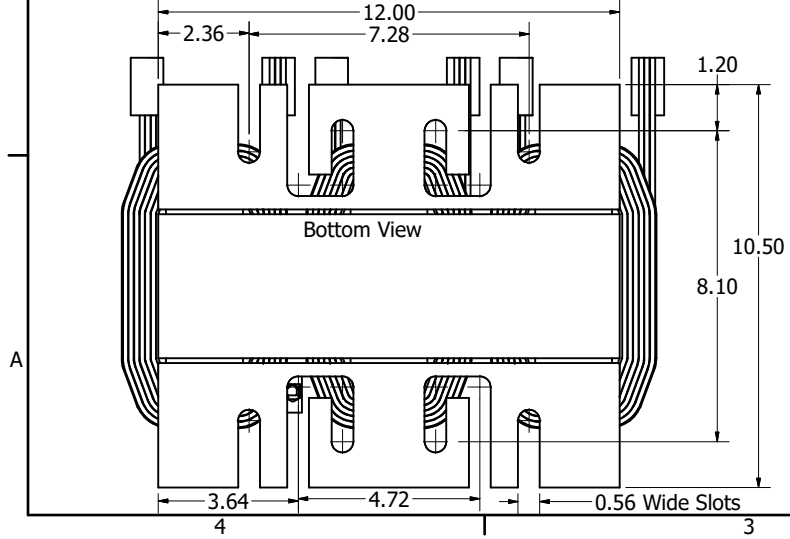
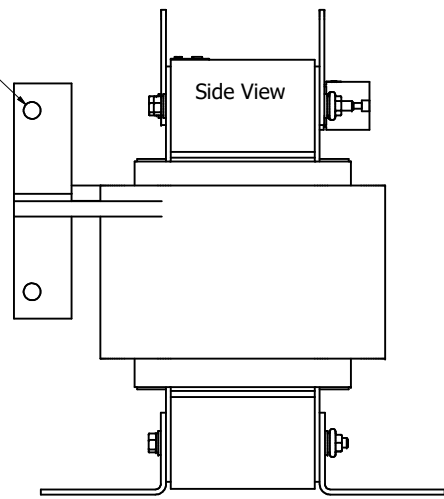

TCI (800) 824-8282 • www.transcoil.com

TCI, LLC
Germantown, WI
www.transcoil.com
800-824-8282

KDR Drive Reactor
KTRMG— (Motor Amps) Or (Rating Amps)
3 Ph, 50/60Hz, 600V Max. —Max.
40C Amb Max, 150C Rise.

Customer Is Responsible For Installation to Meet All National And Local Electrical Codes.

Material(s) Shall be RoHS Compliant

TCI, LLC CLAIMS PROPRIETARY RIGHTS IN THE MATERIAL HEREIN DISCLOSED. IT IS SUPPLIED WITHOUT PREJUDICE TO ANY PATENT RIGHTS OF TCI AND MAY NOT BE REPRODUCED OR USED TO MANUFACTURE ANYTHING SHOWN THEREIN WITHOUT WRITTEN PERMISSION FROM TCI.				TOLERANCES (EXCEPT AS NOTED)		W132 N10611 Grant Drive Germantown, WI 53022	
				DECIMAL		KTRMG S Frame, Copper Bus Reactor Drawing	
				.XX ±.25 .XXX ±.10		DRN BY: DSW DATE: 11/26/19 108095-1DG SCALE: 1/2.5 DRVID: HSE	
				FRACTIONAL		1/16 ANGLAR ± 1°	
A	Was Drawing 101945	11/26/19	DSW				
NO	REVISION	DATE	BY			SHT 1 OF 1	