

KPCUL020C63, 600V, 20kVar
 Approx. Weight: 10 Lbs

Customer Input	
Wire Range	Tightening Torque
8-2/0 Awg	35.5 Lb-In

Cap Connection	
Wire Range	Tightening Torque
14-4 Awg	17.5 Lb-In

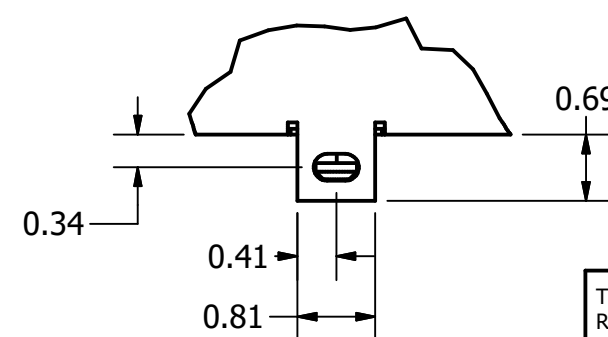
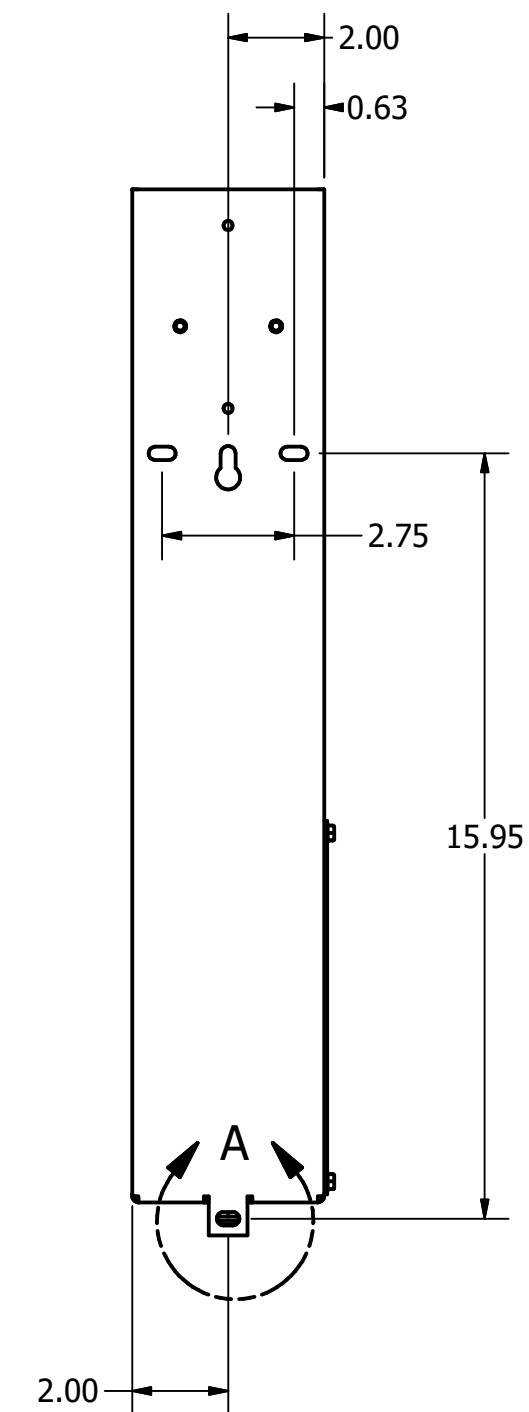
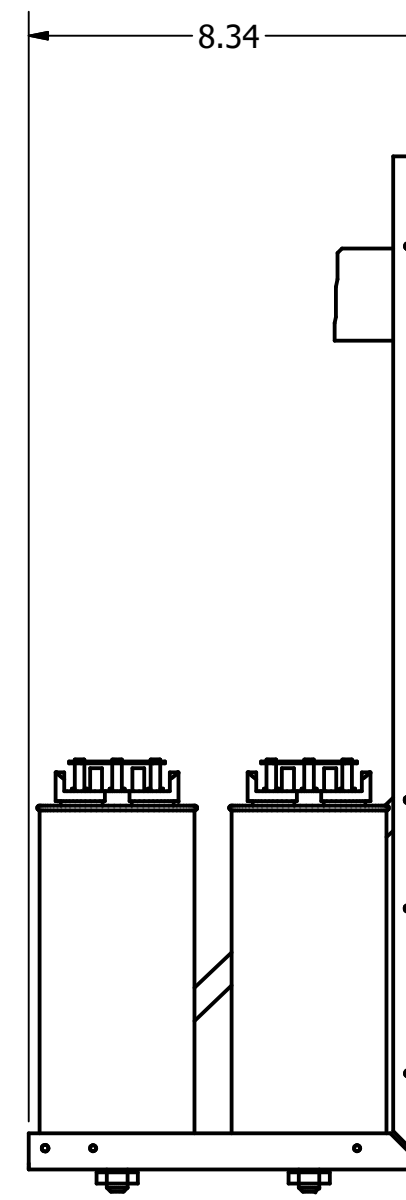
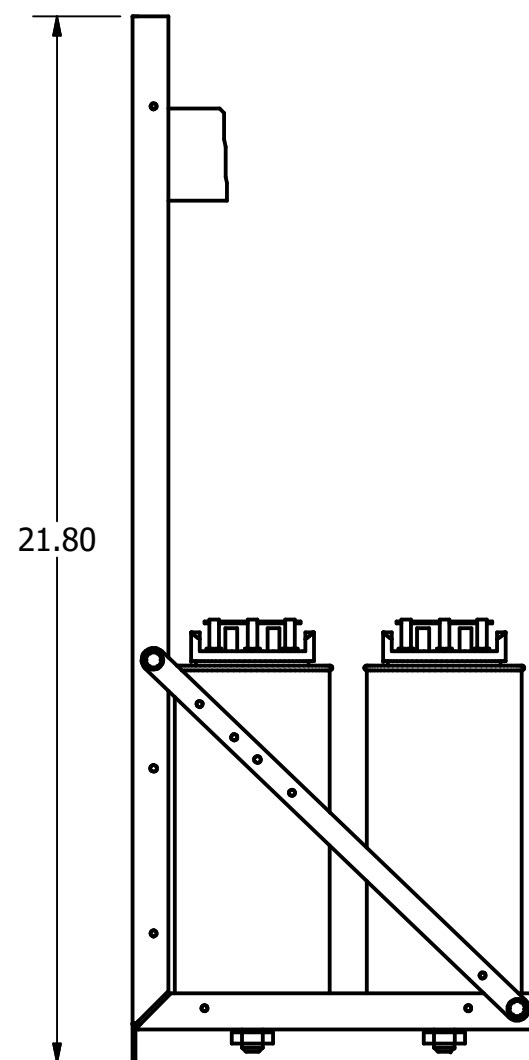
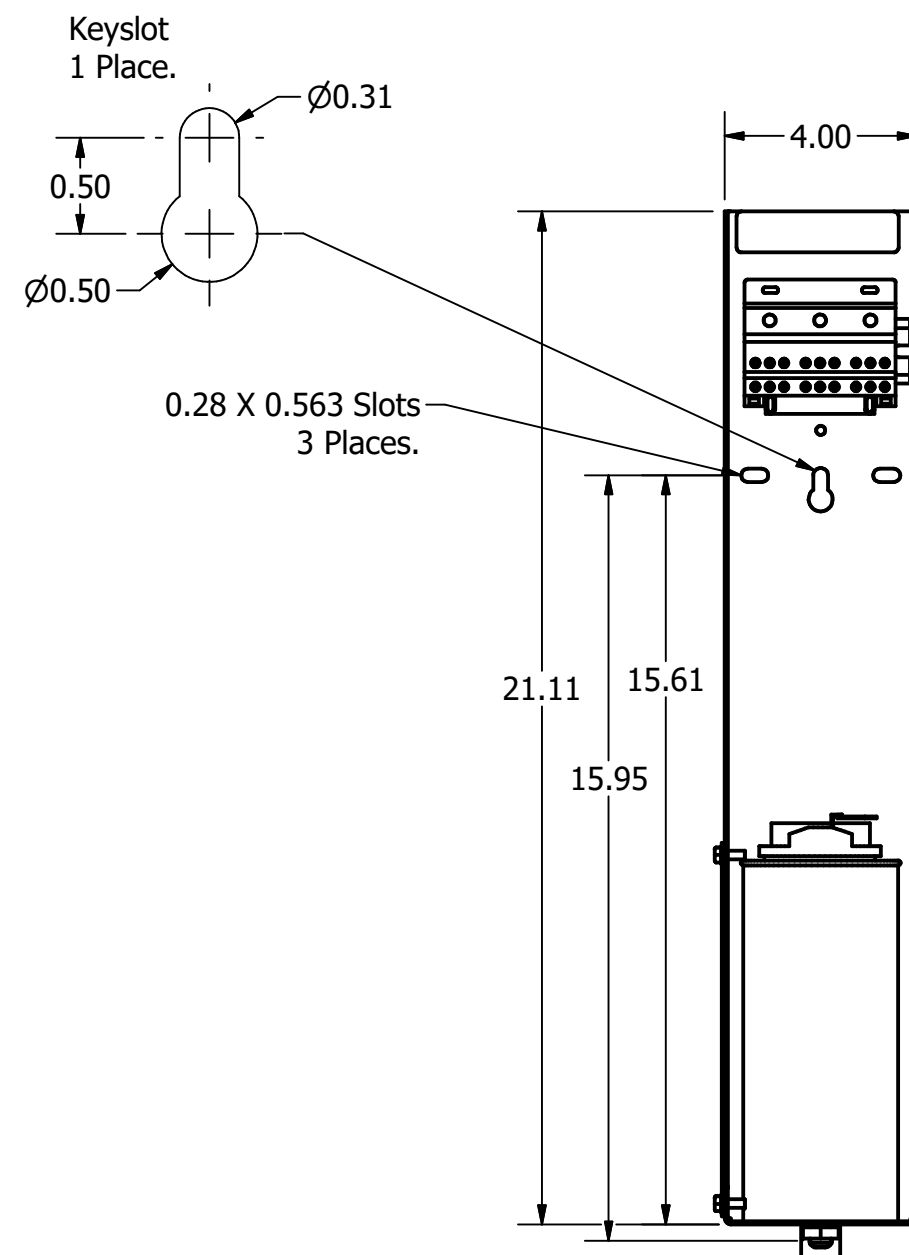
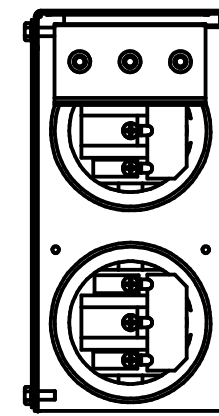
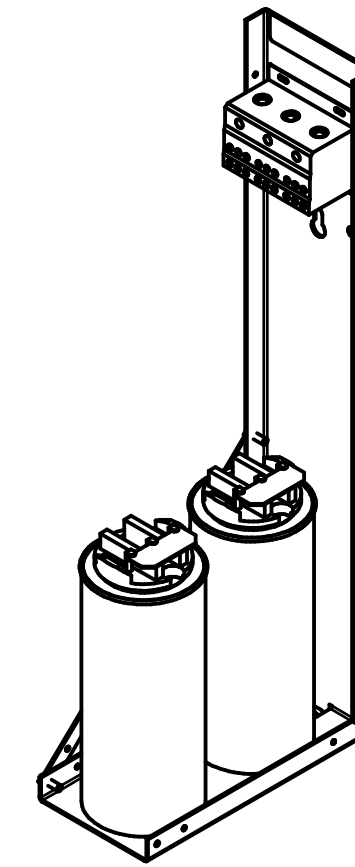

Note: 27908, Manual KPC Installation Guide
 MUST SHIP WITH EACH ASSEMBLY.

HOLE TOLERANCE ± .005

TCl, LLC CLAIMS PROPRIETARY RIGHTS IN THE MATERIAL HEREIN DISCLOSED. IT IS SUPPLIED WITHOUT PREJUDICE TO ANY PATENT RIGHTS OF TCl AND MAY NOT BE REPRODUCED OR USED TO MANUFACTURE ANYTHING SHOWN THEREIN WITHOUT WRITTEN PERMISSION FROM TCl.

TOLERANCES (EXCEPT AS NOTED)			
	DECIMAL		
	.XX ± .25		
	.XXX ± .10		
	FRACTIONAL		
	± 1/16		
	ANGULAR		
	± 1°		

TCl W132 N10611 Grant Drive
 Germantown, WI 53022

KPCUL020C63, 125HP, 20kVar
 Panelized Caps, Low C and Sine Wave

DRN BY: JRN DATE: 10/18/2017 107368DG
 SCALE: APRVD: SIZE: C
 SHT. 1 OF 1

NO.	REVISION	DATE	BY
A	As Designed	10/18/2017	JRN