

SEE V1K INSTALLATION GUIDE FOR TERMINAL WIRE SIZE AND TORQUE
 NOTE: MAINTAIN CLEARANCE OF 3 INCHES ON ALL SIDES TO OTHER EQUIPMENT

V1K Part Number	Max Voltage	Amps	Phase	Weight (LBS)
V1K305A03	600	305	3	109
V1K305A03EX	600	305	3	109
V1K362A03	600	362	3	109
V1K362A03EX	600	362	3	109

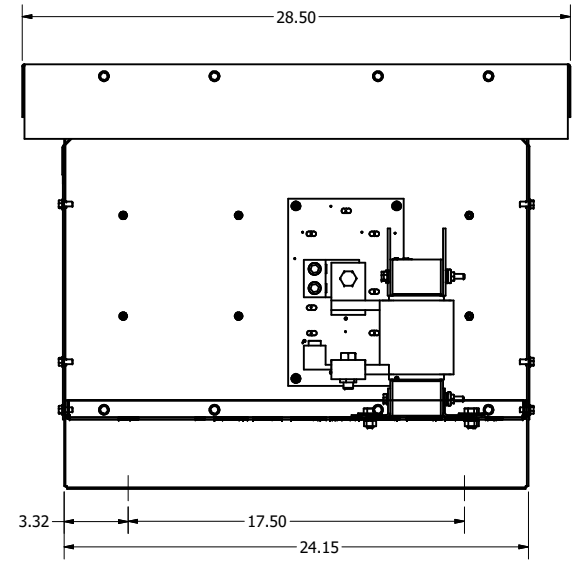
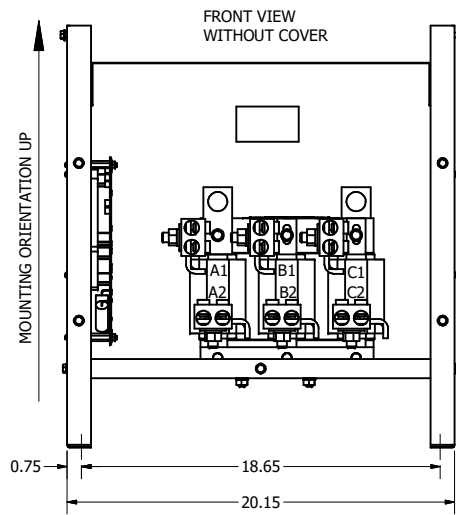
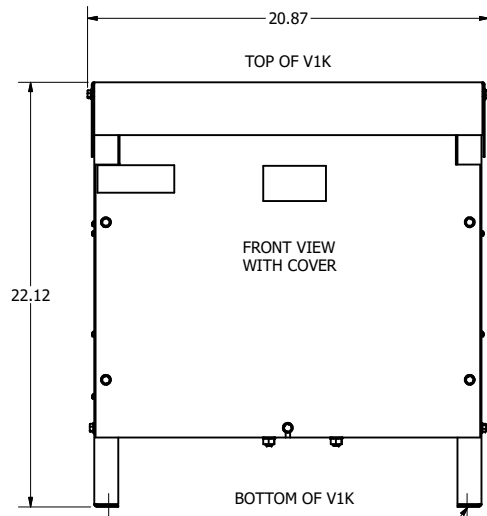
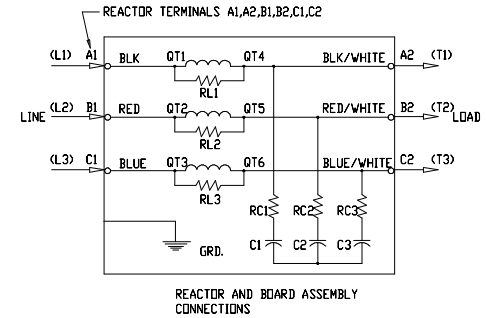
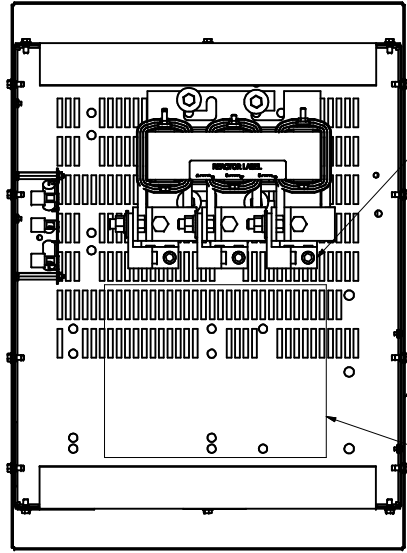

0.50 DIA MOUNTING HOLES
 4 PLACES

NOTE: USE ONLY HUBS OR FITTINGS THAT COMPLY WITH UL514B FOR TYPE 3R ENCLOSURES

CUSTOMER IS RESPONSIBLE FOR INSTALLATION TO MEET ALL NATIONAL AND LOCAL ELECTRICAL CODES

MATERIAL(S) SHALL BE ROHS COMPLIANT

TCI, LLC CLAIMS PROPRIETARY RIGHTS IN THE MATERIAL HEREIN DISCLOSED. IT IS SUPPLIED WITHOUT PREJUDICE TO ANY PATENT RIGHTS OF TCI AND MAY NOT BE REPRODUCED OR USED TO MANUFACTURE ANYTHING SHOWN THEREIN WITHOUT WRITTEN PERMISSION FROM TCI.			TOLERANCES (EXCEPT AS NOTED) DECIMAL .XX ± .25 .XXX ± .10		TCI W132 N10611 Grant Drive Germantown, WI 53022 V1K, TYPE 3R 305 Amps, 362 Amps
F	4658 Rated To Max Voltage	03/04/19	JRN	FRACTIONAL ± 1/16	
E	4030 DRAWING UPDATE	7/7/17	JSM	ANGULAR ± 1°	DESIGNED BY: JSM DATE: 6/29/17 DRAWN BY: JSM SCALE: NONE FILE NO: 104235DG SHEET: 1 OF 1